



available from



Door Closers | Flush Bolts | Electric Strikes  
Deadlatches | Panic Exit Devices



# Index

## CONTENTS

Products		Page No.
Intro		3
Door Closers	TC-8800	4
	TC-9600	5
	TC-9900-ADJ	6
	Accessories	7
Flush Bolts	FB-6200	8
	FB-6300	9
	FB-6400	9
	Accessories	10
Electric Strikes	ES-2200	11
Locks & Deadlatches	LK-2100	12
	Accessories	13
	LK-1800	14
	Accessories	15
Panic Exit Devices	PR-7200	16
	PR-7085	17
	LH-725	17
Part Code Overview		18

## WELCOME

Axim offer a comprehensive range of secure, neat, durable and reliable closing solutions, panic exit devices, electric strikes, deadlatches and flush-bolts perfectly designed for commercial aluminium door-sets. Axim products not only conform to the latest building regulations and trade association guidelines, but their transom closers also achieve the reduced closing forces required to comply with the Disability Discrimination Act (DDA) in the UK.

## Door Closers

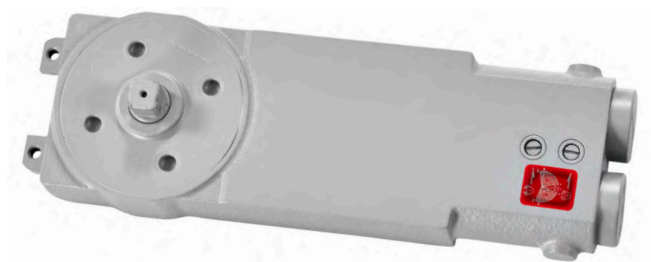

Here, you'll find a closing solution to suit most aluminium door sets. And because the system is completely hidden within the door leaf and transom, it eliminates the need for any additional external hardware, for clean aesthetics and uninterrupted lines. Choose from Axim's fully adjustable TC-8800 series closers, TC-9600 series closers with extended side load or end load fittings available and the cost-effective TC-9900 replacement closer.

## Flush Bolts & Keeps



Axim flush bolts secure the slave leaf on double aluminium doors at the top and bottom with a hardened steel 18mm diameter bolt that achieves maximum protection against unauthorised access. To aid assembly, all fixings are included, corners are 2.5mm radiused for easy matching to the cut-out, a centre punch helps locate the centre of the keep and all holes are pre-drilled and countersunk for M fixings.

## Electric Strikes



Axim's ES-2200 electric strikes or electric door releases are designed to work with most deadlocks, as well as the Axim LK-2100 deadlatch, to create an access control system to secure a door. Whether you want fail-safe mode (so the door stays unlocked if the power fails) or fail-secure mode (so the door is locked in the event of a power outage) the ES-2200 will work for both. Axim electric strikes can also be configured on site to suit 12V or 24V systems.

## Locks & Deadlatches

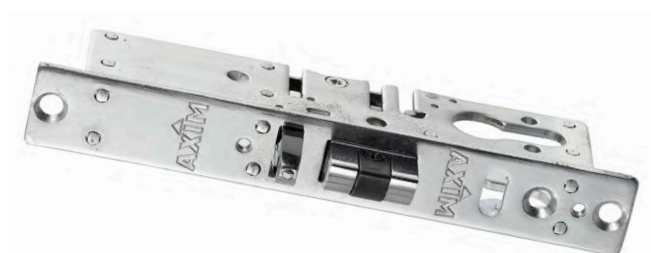

Axim LK-1800 series hook locks and LK-2100 series deadlatches deliver secure locking for a variety of commercial aluminium and steel doors including swing and sliding systems, providing flexible access control during and after business hours. Axim locks and deadlatches are designed to accept euro profile cylinders and are available in three different backsets.

## Panic Exit Devices



Axim's PR Series of emergency and panic exit devices not only provide a reliable, easy-to-operate means of escape in the event of a fire or emergency, they offer excellent burglar protection too. Whether you want a BE EN 1125 compliant panic exit device operated by a horizontal bar for a public building or a BS EN 179 compliant emergency exit device operated by lever handle or push pad for an office space, you'll find an Axim solution to meet your needs.



# TC-8800 Size 2

## Concealed Overhead Transom Closer

### PRODUCT INFORMATION



The Axim TC-8800 universal concealed closer is a hidden commercial closing solution held integrally in the door leaf and transom. This means that the door requires no external hardware to create an uncluttered and secure solution. Choose from a variety of door control options to achieve the desired level of functionality such as no-hold opening for low-traffic areas or 90° hold-open for high traffic installations. The TC range is fully adjustable vertically and laterally so it's easy to ensure smooth operation and perfect closing.

- Includes body unit and fixings – 70mm bracket size 2
- Suitable for single and double action doors
- 10mm and 15mm extended spindle models
- 2 valves for closing and latching speed adjustment
- Pre-set cushion back-check
- No hold-open or mechanical hold-open at 90° in stock (hold-open 105° available by special order)
- Suitable for door widths 751mm to 950mm
- Maximum door leaf weight 100Kg
- Standard & Anti finger trap package options are available
- Dummy unit available
- Conforms to EN 1154
- 30-month manufacturers guarantee

### TECHNICAL DRAWINGS

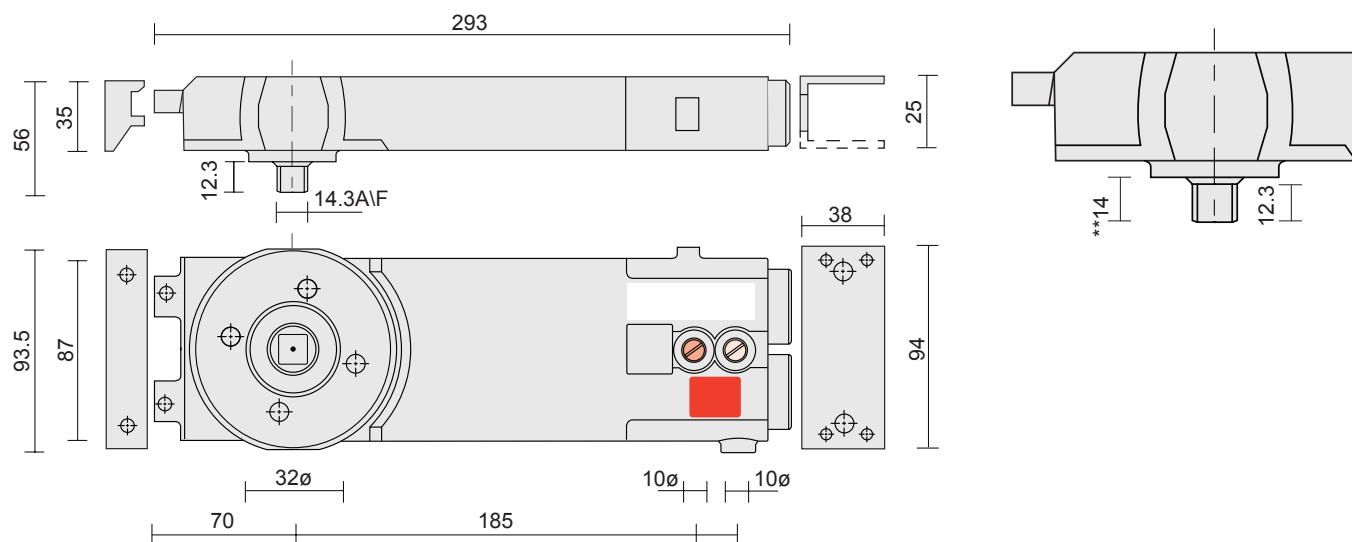

### PART NUMBERS

Size	Hold-open	No Hold-open	Spindle Extension	Part Code
2		•	-	ATC880200
2	•		-	ATC880290
2		•	10mm	ATC8802010
2	•		10mm	ATC8802910
2		•	15mm	ATC8802015
2	•		15mm	ATC8802915

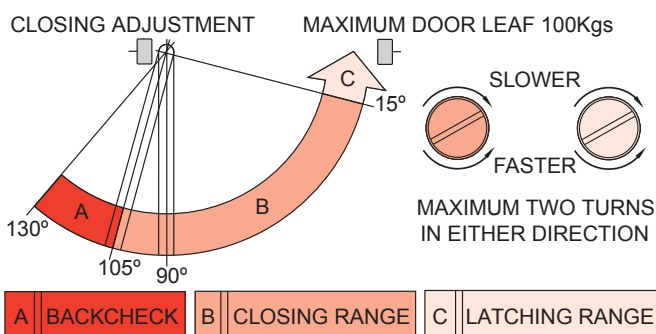



**AXIM**  
ARCHITECTURAL HARDWARE

- Includes body unit and fixings – 70mm bracket size 2
- Suitable for single and double action doors
- Extended spindle compared to TC-8800
- 2 valves for closing and latching speed adjustment
- Pre-set cushion back-check
- No hold-open or mechanical hold-open at 90°
- Size 2 closer suitable for door widths 751mm to 950mm
- Maximum door leaf weight 100Kg
- Standard & Anti finger trap package options are available
- Dummy unit available
- Conforms to EN 1154
- 30-month manufacturer's guarantee

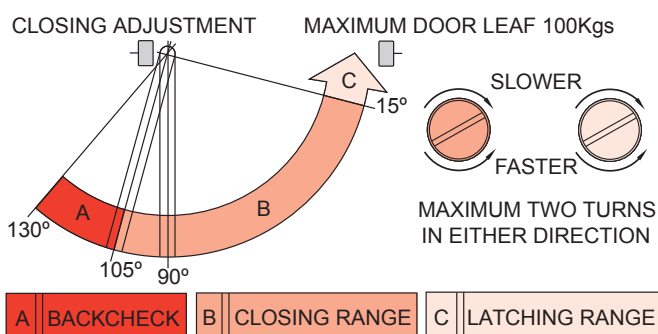
[illegible]

Size	No Hold-open	Hold-open	Part Code
2	•		ATC960200
2		•	ATC960290



# TC-9900-ADJ Series Universal Concealed Overhead Transom Closer

## PRODUCT INFORMATION



The TC-9900 universal concealed door closer offers a sleek and smooth-operating closing solution for both new commercial door installations and replacement applications where other leading transom closers have failed. Quick and easy to fit, it will confidently replace the Axiom TC-8800 series closer, as well as other leading brands such as Dorma, Peters Jackson, Newman, Tonks, Ryobi - all without costly modifications to the door or door frame.

- Includes body unit and universal fixings – 70mm bracket
- Suitable for single and double action doors
- 2 valves for closing and latching speed adjustment
- Pre-set cushion back-check
- No hold-open or mechanical hold-open at 90°
- Suitable for closer sizes 1-4 and door widths 750-1150mm
- Maximum door leaf weight 100Kg
- Standard & Anti finger trap package options are available
- Dummy body unit available
- Conforms to EN 1154
- 30-month manufacturer's guarantee

## TECHNICAL DRAWINGS

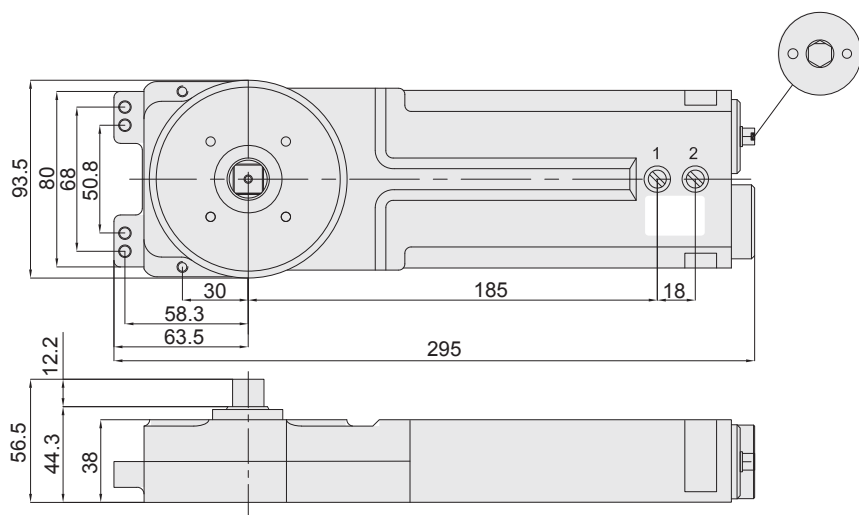

	CLOSER SIZE			
	1	2	3	4
NUMBER OF TURNS	+0	+2~+4	+5~+7	+8

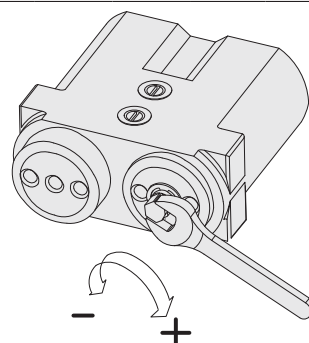

## PART NUMBERS

Size	No Hold-open	Hold-open	Part Code
Adjustable	•		ATC990000
Adjustable		•	ATC990090

### CLOSING ADJUSTMENT

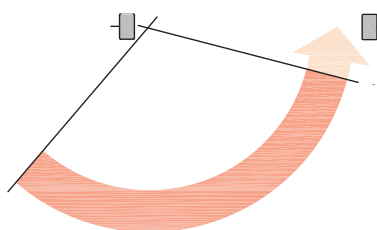

Independent valve screws permit closing speed adjustment from fully open to 15° and 15° to closed.

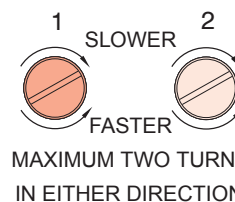

# Side Load and End Load Arms for Transom Closers



## PRODUCT INFORMATION

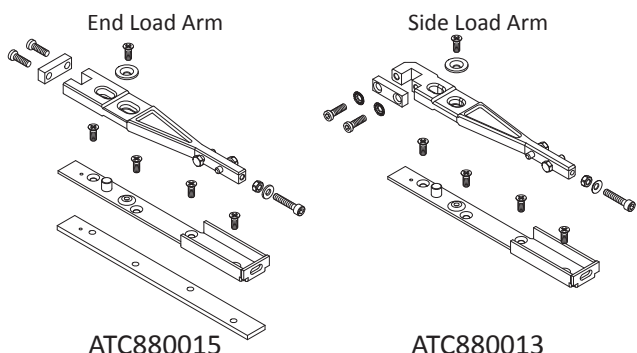

These arms are an essential component of the concealed transom door closer system. Available as either side loading (suitable for use on anti-finger trap doors, armour glass doors and those with a round door stile or narrow door rail) or end loading (for use with anti finger trap doors). These products are fully adjustable, come with hexagonal spanner and feature handy hole and centre lines in channel for easy location of pivot point.



End load- The door is fitted in the open position therefore the cut-out for the transom spindle is at the end of the arm – hence end load



Side load- The door is fitted in the closed position. Therefore the spindle cut-out is at the side of the arm – hence side load.

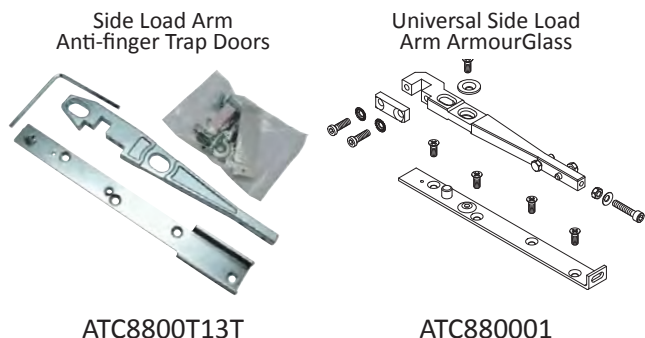

## PART NUMBERS

Description	Size	Part Codes
End Load Arm	260 x 36.8 x 21mm	ATC880015
Side Load Arm	263 x 35 x 16mm	ATC880013T
Standard Side Load Arm - Anti-finger Trap Doors	260 x 34.2 x 16mm	ATC880013
Universal Side Load Arm - Armour Glass	260 x 34.2 x 16mm	ATC880001

# Bottom Pivot Assembly for Transom Closers



## PRODUCT INFORMATION

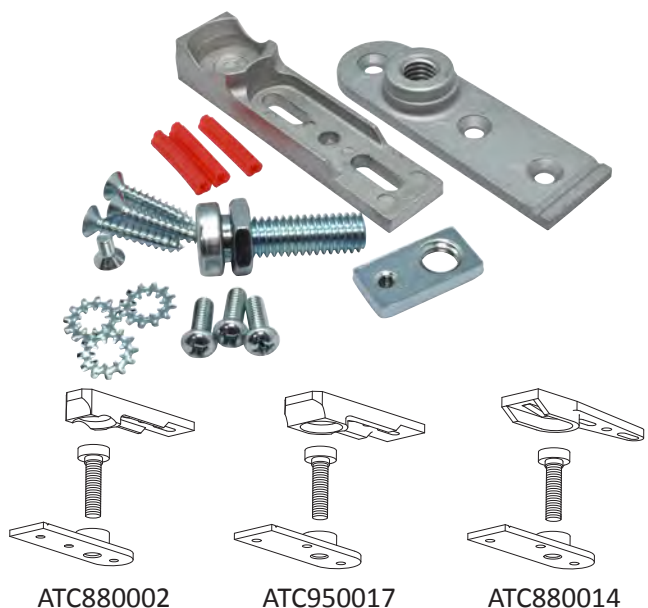

This bottom pivot assembly is an essential component of the concealed transom door closer system. It holds and supports the weight of the door and enables it to swing open and closed. Choose between standard side loading, end-loading or heavy duty bottom pivots which are used with anti-finger trap doors

## PART NUMBERS

Description	Part Codes
Standard Bottom Pivot	ATC880002
Heavy Duty Bottom Pivot	ATC950017
Heavy Duty Bottom Pivot Anti-finger Trap Doors	ATC880014



# FB-6200

## 23mm Wide Flush Bolts

### PRODUCT INFORMATION



These finger-operated shoot bolts work to secure the slave leaf on double aluminium door assemblies. They are rebated into the leading edge or inside face of the door and operated by a lever which sits flush when the bolt is engaged and the door is closed. To ensure ease of operation, Axim FB series flush bolts have a deep finger recess and large lever. A standard installation requires two flush bolts morticed into the top and bottom of the door. For maximum security the Axim flush bolt has a hardened steel bolt, zinc plated with an anti-rattle sleeve.

- Smooth lever action flush bolts
- Radiused faced or flat faced available
- Mounted in the leading edge or inside face of the slave leaf of a pair of doors
- Manufacturer's guarantee: 30 months
- Available in one fully threaded length, 305mm (12") which can be cut to suit
- Silver satin chrome finish
- Shoot bolt: 18 mm diameter and a die cast zinc alloy body mechanism
- Fixings included

### TECHNICAL DRAWINGS

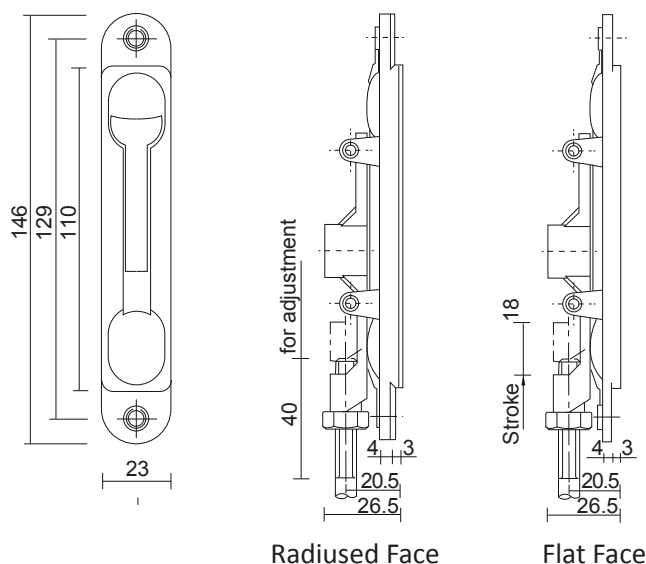

### PART NUMBERS

Face Plate	Length	Part Code	Box Qty
Radius Face	305mm	AFB620112R	1
Square Face	305mm	AFB620112F	1



## A close-up photograph of a metal latch mechanism mounted on a red door frame. The latch is silver-colored and features two circular knobs. It is secured to the frame with two screws. The background is a blurred view of a cloudy sky.

- Hardened steel zinc plated bolt with anti-rattle sleeve
- 18mm bolt stroke
- 7mm zinc plated steel rod with fully threaded length for easy adaption to non-standard door installations
- Length: 110mm or 230mm
- “Centre Punch” tip to mark centre of keep
- Die cast zinc alloy body mechanism
- Fixing holes tapped M5
- Fixings included
- Manufacturer’s guarantee: 30 months
- Deep finger recess and large lever for ease of operation
- Available in 20mm widths

Type	Width	Rod Length	Part Code	Box Qty
FB-6400	20mm	110mm	AFB64110	10
FB-6300	20mm	230mm	AFB64230	10



# FB-6200 Series Flush Bolt Extension Rods

## PRODUCT INFORMATION



These extension rods work with the Axim FB-62 Series Flush Bolts to accommodate taller doors.

- Choose from 20" or 36" lengths
- 30 months manufacturer's guarantee

## PART NUMBERS

Bar Length	Part Code
20 inch	AFB62200
36 inch	AFB62360



# Flush Bolt Sprung Loaded Socket Keep

## PRODUCT INFORMATION



This floor socket keep works with Axim FB-6200 and FB-6000 series flush bolts.

- Sprung loaded
- Dust resistant
- Satin chrome finish
- 30 months manufacturer's guarantee

## PART NUMBERS

Height	Top Diameter	Bottom Diameter	Part Code
465mm	35mm	21.2mm	AFB62035

# ES-2200 Electric Strike



## PRODUCT INFORMATION

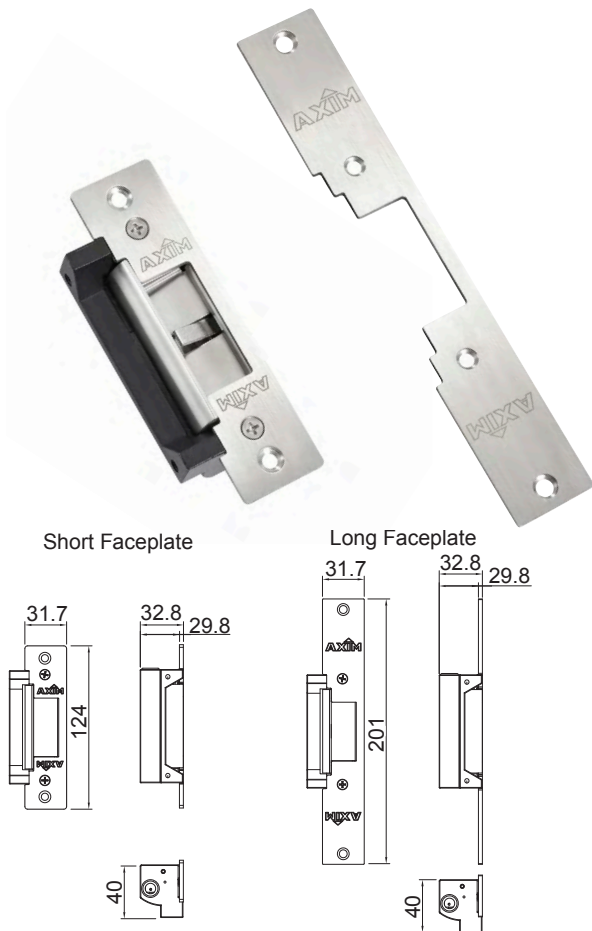

The Axim ES-2200 series of electric strikes are an ANSI style door release designed to work with most leading brand deadlocking night latch locks. They come complete with stainless-steel short and long faceplates for use in most metal or timber door frame applications. The Axim ES-2200 series are shipped as fail-secure and can be converted to fail-safe mode by the simple removal of a screw. The Axim ES-2200 can also be set to 12V or 24V by simply re-configuring the wires in a different sequence.

- 450kg Holding Force
- Simple fail-safe/fail-secure changeover
- Easy installation
- Can be set to 12/24V AC/DC on site
- AC fail-secure only & DC fail-safe/fail-secure
- Comes with stainless-steel flat design face plates in two sizes:  
Short: 124mm x 31.7mm, Long - 201.5mm x 31.7mm
- Simple, effective replacement for most leading brand ANSI electric releases
- Supplied with 250mm of cable
- 10mm, 25mm and 50mm extension lips available
- Power consumption and current draw:  
12/24V DC – 300mA, 24/24V DC – 150mA

## PART NUMBERS

Description	Part Code
Electric Strike	AES22000S

# Extension Lip for ES-2200 Electric Striker



## PRODUCT INFORMATION



If you're fitting the Axim ES-2200 electric strike to a deep door frame, then these extension lips will help to protect the frame and create a neater, professional finish on the install cut-out.

- Available in three sizes – 10mm, 25mm or 50mm

## PART NUMBERS

Description	Size	Fixings
Extension Lip for ES-2200 Electric Striker	10mm	AES220010
Extension Lip for ES-2200 Electric Striker	25mm	AES220025
Extension Lip for ES-2200 Electric Striker	50mm	AES220050



# LK-2100 Series Reversible Deadlatch

## PRODUCT INFORMATION



The Axim LK-2100 series fully reversible deadlatch is non-handed for ultimate flexibility, cost-effectiveness and reduced stock holding. The LK-2100 deadlatch series accepts euro profile cylinders, with a choice of 25, 28 and 38mm backsets and strike plates to suit most single and double door configurations. An all metal case, sturdy construction and hardened steel pins help to prolong life and resist burglar attack.

- Latch bolt can be reversed without opening the deadlatch case
- Accepts euro profile cylinders
- 3 backsets available: 25mm, 28mm and 38mm
- Strike plates available to suit single and double door applications
- A reverse turn of the key while the bolt is retracted retains the latch in the case to allow two-way traffic when required
- All metal case and strong construction prevent certain unauthorised case entry
- Flat face or radius face faceplates available separately
- Suitable for use with the ES-2200 Electric Strikes
- 30 months manufacturer's guarantee

## TECHNICAL DRAWINGS

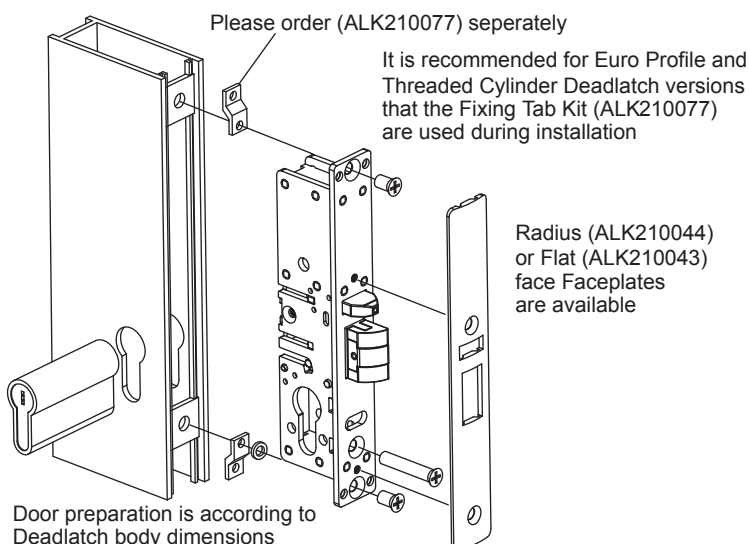
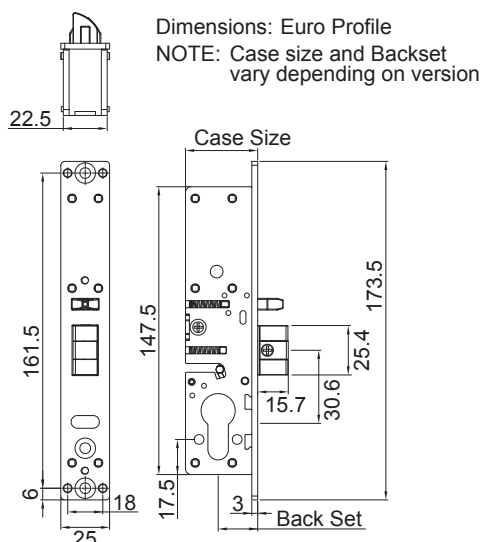

## PART NUMBERS

Cylinder Type	Backset	Part Code	Box Qty
Euro Profile	25mm	ALK21025E	12
Euro Profile	28mm	ALK21028E	12
Euro Profile	38mm	ALK21038E	12

# Faceplate for LK-2100 Series Reversible Deadlatches

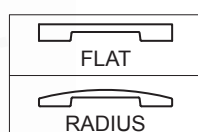
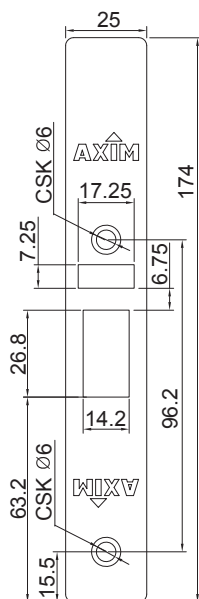

These faceplates are used with Axim's LK-2100 Series euro profile reversible deadlatches to offer flexible access control on commercial doors both during and after business hours.

- Flat or radius faceplates available
- Natural satin silver anodized finish
- Specified for use alongside the Axim ES-2200 Electric Striker
- The fixing tab kit (ALK210077 below) is recommended for use during installation
- 30-months manufacturers guarantee

## PART NUMBERS

Description	Shape	Part Code	Box Qty.
25 x 174mm	Flat Face	ALK210043	1
25 x 174mm	Radius Face	ALK210044	1

# Faceplate Fixing Tab Kit for LK-2100 Series Reversible Deadlatches

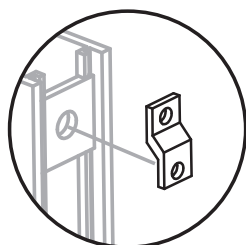

These fixing tab kits are recommended for use during installation and help to ensure the faceplate is installed firmly and securely into a euro profile door.

## PART NUMBERS

Description	To Fit	Bar Length	Box Qty.
Fixing Tab	LK-2100	ALK210077	1 pair

# Flat Strike Plate for LK-2100 Reversible Deadlatch



These flat strike plates are used with Axim's LK-2100 Series euro profile reversible deadlatches to offer flexible access control on commercial doors both during and after business hours.

- Available widths: 48mm & 72mm

## PART NUMBERS

Width	Part Code	Box Qty.
48mm	ALK216516	1
72mm	ALK217515	1

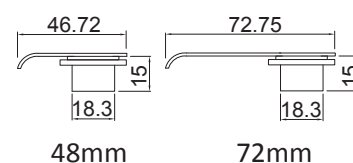



# LK-1800 Series Mortice Hook Lock

## PRODUCT INFORMATION



If you're looking for a secure and affordable quality deadlocking system for narrow stile hollow metal doors, then the Axim LK-1800 mortice hook lock is just the job. A heavy-duty 5 ply laminated hook lock clasps the keep and stops the door from being separated from the frame, while a hardened case and roll pin resists hacksawing. The LK-1800 series accepts standard euro and round profile cylinders, with a choice of 25, 30 and 40mm backsets to suit most single and double aluminium or steel door configurations.

- Hacksaw-resistance 5-ply laminated hook bolt, hardened centre case and roll pin
- 19mm bolt throw
- Suitable for centre hung or offset pivot double or single aluminium and steel door assemblies
- Available in 25mm, 30mm and 40mm backset options
- Axim locks are designed to accept euro profile cylinders as standard (round cylinder version on special order)
- Flat (ALK18010F) or radius (ALK18010R) faceplates available with a natural satin silver anodized finish
- Steel case and mechanism have a corrosion-resistant zinc coating
- 30 months manufacturer's guarantee

## TECHNICAL DRAWINGS

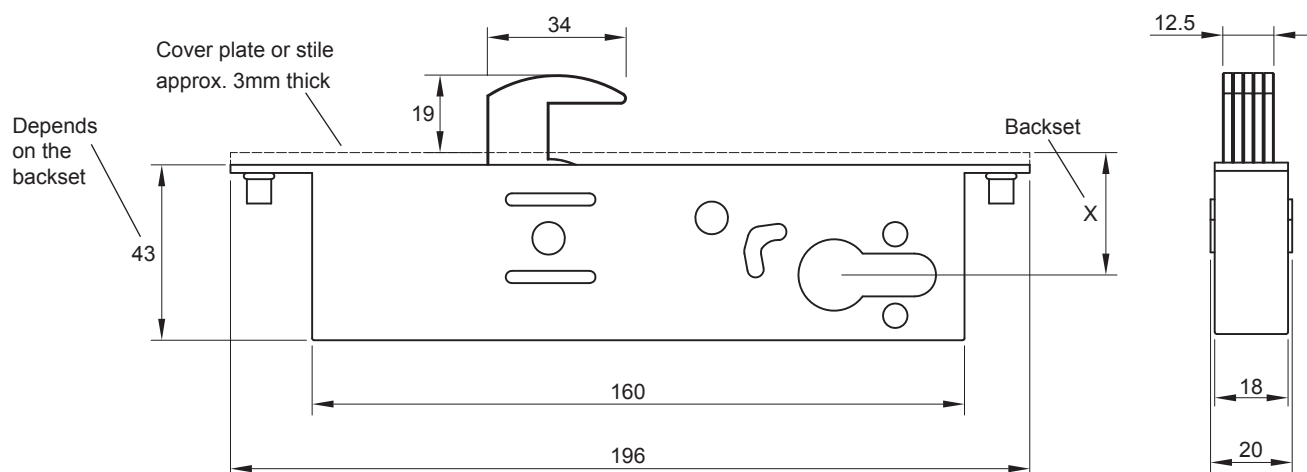

## PART NUMBERS

Locking Type	Case Size	Backset	Part Code	Box Qty
Hookbolt	196 x 18 x ?mm	25mm	ALK18025E	1
Hookbolt	196 x 18 x 43mm	30mm	ALK18030E	1
Hookbolt	196 x 18 x ?mm	40mm	ALK18040E	1

# Faceplate for LK-1800 Series Mortice Hook Lock



## PRODUCT INFORMATION

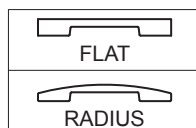
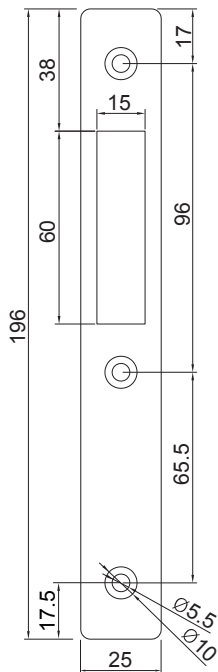

These faceplates are used with Axim's LK-1800 Series Mortice Hook Locks to deliver secure and affordable quality deadlocking on aluminium or steel commercial door installations.

- Flat or radius faceplates available
- Natural satin silver anodized finish

## PART NUMBERS

Finish	Size	Shape	Part Code	Box Qty.
Silver	163 x 25 x 2.85mm	Square	ALK18010F	1
Silver	163 x 25 x 2.85mm	Radius	ALK18010R	1

# Pair of Mounting Bridges for LK-1800 Series Mortice Hook Lock



## PRODUCT INFORMATION

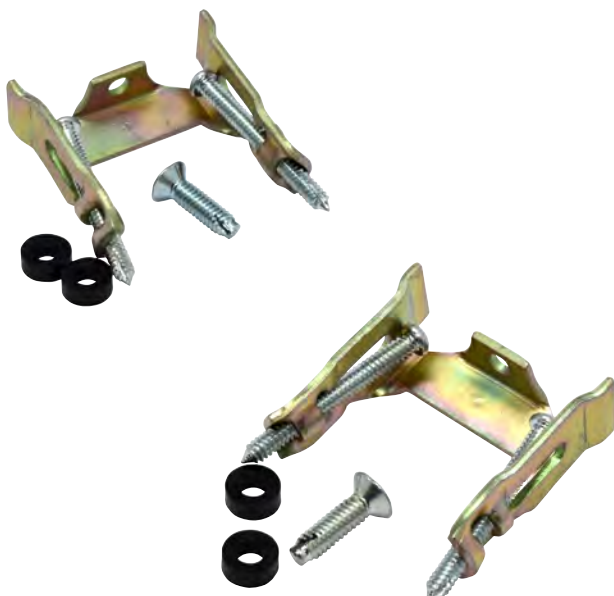

These mounting bridges are recommended for use when fitting the Axim LK-1800 mortice hook lock. They sit inside the master leaf on an aluminium door set and the main lock is screwed to them.

## PART NUMBERS

Description	Part Code	Box Qty.
Mounting Bridges	ALK181133	1 pair



# PR-7200 Series Full Width Release Panic Bar Exit Device

## PRODUCT INFORMATION



The Axim PR-7200 is a full width, soft touch non-handed panic exit device with a concealed vertical rod which secures the top and bottom of the door. To open the door, the rods are retracted with a turn of a cylinder key or when the touch bar is locked down with an Allen key (dogged).

- The internal mechanism is manufactured from stainless and plated steel
- 8.5mm diameter steel operating rods provide a 16mm bolt throw
- Optional external key access also available.
- The push bar is extruded aluminium in an anodised finish with coloured alloy end caps to match
- All mounting screws are concealed
- Available in 3 standard widths (36", 42" & 48") which can be cut to size
- BS EN 1125 compliant
- 30 months manufacturer's guarantee

## TECHNICAL DRAWINGS

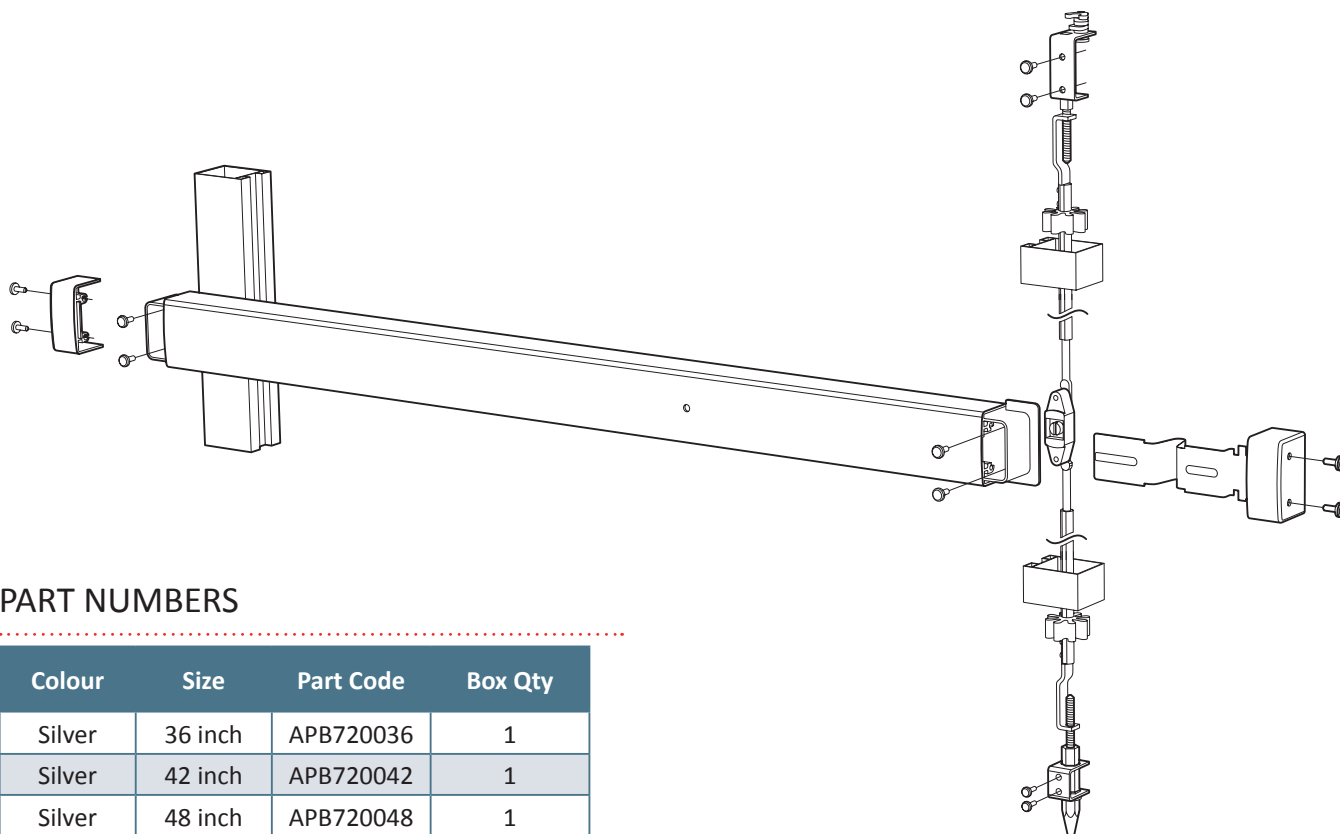

## PART NUMBERS

Colour	Size	Part Code	Box Qty
Silver	36 inch	APB720036	1
Silver	42 inch	APB720042	1
Silver	48 inch	APB720048	1

# PR-7085 Concealed Rod Panic Bar Exit Device



## PRODUCT INFORMATION



The Axim PR Series is a range of concealed vertical rod crash bar panic exit devices which are compliant to BS EN 1125 to give even unfamiliar users a quick and straightforward way to escape a building.

- BS EN 1125 compliant
- Cross bar is made from extruded aluminium in a silver satin finish
- All housings and lever arms are finished in an abrasive resistant finish to compliment the crossbar anodising
- Heavy duty lever springs deliver durable operation of the lever arms
- Standard model suitable for narrow and wide stile doors up to 2135mm high and 1155mm wide
- All fixings are concealed to ensure streamlined looks
- Projection from the door: 120x186mm
- Permanent latch retention by either cylinder key from the outside or concealed pins under the levers
- Non-handed and left- or right-hand paddle handle option
- 30 months manufacturer's guarantee

## PART NUMBERS

Description	Colour	Handing	Part Code	Box Qty
Panic Bar	Silver	-	APB70851	1
Panic Bar	Silver	Left Hand	APB70851L	1
Panic Bar	Silver	Right Hand	APB70851R	1

# LH-725 Outside Access Locking Handle



## PRODUCT INFORMATION

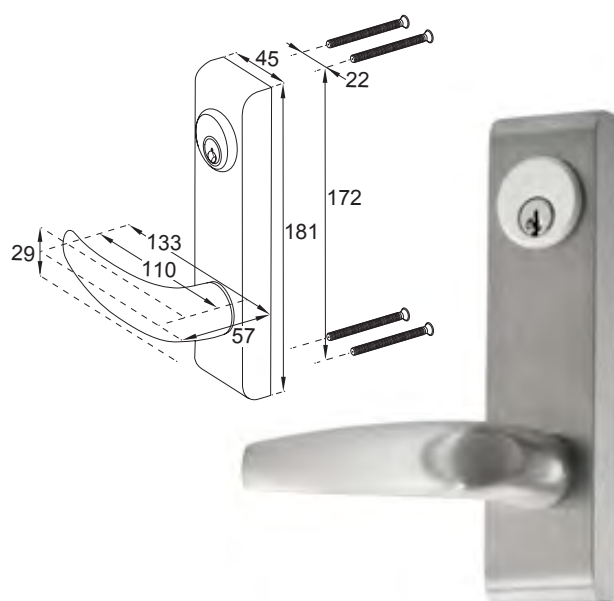

The Axim LH-7 Series lever handles work with the PR-7085 panic bar exit devices to allow key-lockable access from the outside, with options to suit a range of door stile widths.

- Key controlled
- Spindle length 9mm
- Suitable for round cylinders only
- Levers available to suit 46, 49, 54 & 67mm door stile widths
- 181 x 45mm backplate, handle 133mm
- 172 x 22mm screw centers
- 30 months manufacturer's guarantee

## PART NUMBERS

Description	Colour	Door Stile	Part Code
Outside Access Lever	Silver	46mm	APB730461
Outside Access Lever	Silver	49mm	APB730491
Outside Access Lever	Silver	54mm	APB730541
Outside Access Lever	Silver	67mm	APB730671



# Overview

SECTION		DESCRIPTION	PART CODE	PAGE NO.
Door Closer	Concealed Overhead Transom Closer TC-8800 Series - Size 2	No Hold-open	ATC880200	4
		Hold-open	ATC880290	4
		10mm Ext. Pin No Hold-open	ATC8802010	4
		10mm Ext. Pin Hold-open	ATC8802910	4
		15mm Ext. Pin No Hold-open	ATC8802015	4
		15mm Ext. Pin Hold-open	ATC8802915	4
	Concealed Overhead Transom Closer TC9600 Series - Size 2 with Extended Spindle	No hold-open	ATC960200	5
		Hold-open	ATC960290	5
	Concealed Overhead Transom Closer TC9900-ADJ Series - Universal	No hold-open	ATC990000	6
		Hold-open	ATC990090	6
	Side Load & End Load Arms for Transom Closers	End Load Arm	ACT880015	7
		Top Side Load Arm	ATC880013T	7
		Standard Top Side Load Arm	ATC880013	7
		Universal Arm	ATC880001	7
	Bottom Pivot Assembly for Transom Closers	Standard Pivot	ATC880002	7
		Heavy-duty Pivot	ATC950017	7
		Heavy-duty Pivot, Anti-finger Trap Doors	ATC880014	7
Flush Bolts & Keeps	FB6200 Flush Bolts 23mm Wide	Radius Flush Bolt 305mm Silver	AFB620112R	8
		Square Flush Bolt 305mm Silver	AFB620112F	8
	FB6300 and FB6400 20mm Wide Flush Bolts	Flat Face (Pack of 10) Rod Length 230mm	AFB64230	9
		Flat Face (Pack of 10) Rod Length 110mm	AFB64110	9
	FB6200 Series Flush Bolt Extension Rods	20 inch	AFB62200	10
		36 inch	AFB62360	10
	Flush Bolt Sprung Loaded Socket Keep	Sprung Loaded Socket Keep	AFB62035	10
Electric Strikers	ES-2200 Electric Strike	Electric Striker 12/24V	AES22000S	11
	Extension Lip for ES-2200 Series Electric Striker	Extension Lip 10mm	AES220010	11
		Extension Lip 25mm	AES220025	11
		Extension Lip 50mm	AES220050	11
Locks & Deadlatches	LK-2100 Series Reversible Deadlatch	25mm Backset	ALK21025E	12
		28mm Backset	ALK21028E	12
		38mm Backset	ALK21038E	12
	Faceplate for LK-2100 Series Reversible Deadlatches	Flat Faceplate Silver	ALK210043	13
		Radius Faceplate Silver	ALK210044	13
	Fixing Tab Kit for LK-2100 Series Reversible Deadlatch Faceplates	Fixing Tab Kit for Axim LK-2100	ALK210077	13
	Flat strike plate for LK-2100 Series Reversible Deadlatch	Striker Plates Flat 48mm	ALK216516	13
		Striker Plates Flat 72mm	ALK217515	13
	LK-1800 Series Mortice Hook Lock	25mm Backset	ALK18025E	14
		30mm Backset	ALK18030E	14
		40mm Backset	ALK18040E	14
	Faceplate for LK-1800 Series Mortice Hook Lock	Square Faceplate Silver	ALK18010F	15
		Radius Faceplate Silver	ALK18010R	15
	Pair of Mounting Bridges for LK-1800 Series Mortice Hook Lock	Mounting Bridges for LK-1800	ALK181133	15
Panic Exit Devices	7200 Series Full Width Release Panic Bar Exit Device	Touchbar 36 Inch Silver	APB720036	16
		Touchbar 42 Inch Silver	APB720042	16
		Touchbar 48 Inch Silver	APB720048	16
	PR-7085 Series Concealed Rod Panic Bar Exit Device	Silver	APB70851	17
		Silver Left Hand	APB70851L	17
		Silver Right Hand	APB70851R	17
	LH-725 Series Outside Access Lever Handle	46mm Door Stile	APB730461	17
		49mm Door Stile	APB730491	17
		54mm Door Stile	APB730541	17
		67mm Door Stile	APB730671	17

# Technical Data On Demand

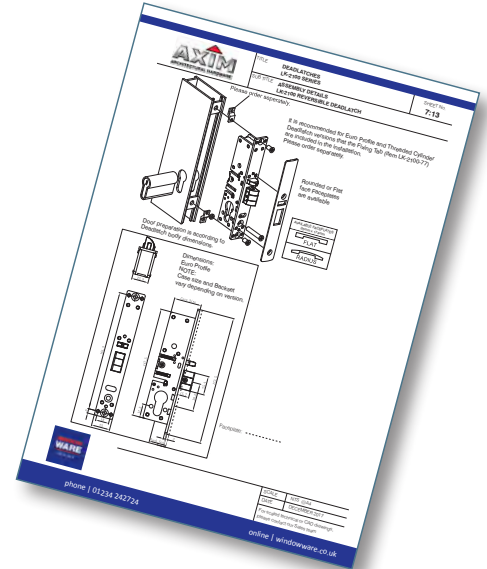
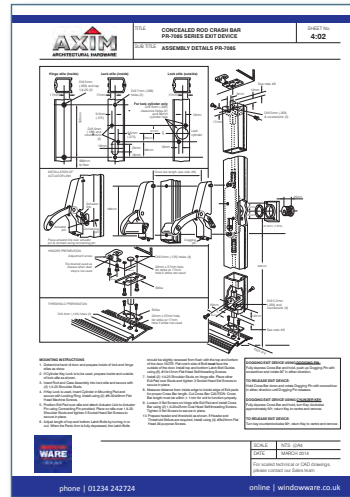
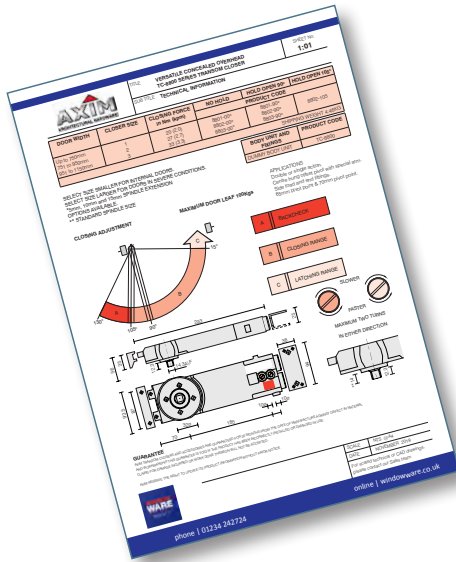

Looking for more detailed information about Axim?

Technical specification sheets are available for every Axim product we stock, giving you full instructions on assembly, installation etc.

To download, visit  
[www.windowware.co.uk/brands/axim](http://www.windowware.co.uk/brands/axim)



*available from*



W: [windowware.co.uk](http://windowware.co.uk)

T : 01234 242724 | E : [sales@windowware.co.uk](mailto:sales@windowware.co.uk)