

# C30 Chain Actuators 300N

## Electric Window Controls

**HIGHLINE®**  
WINDOW CONTROLS

### PRODUCT INFORMATION



This single-chain actuator comes as standard with a selection of different brackets making it suitable for mounting onto top- and bottom- hung windows. It delivers a maximum push/pull thrust force of 300N which is sufficient to operate most windows, lightweight roof vents and domes. The opening stroke can quickly and easily be adjusted at 200mm or 380mm simply by turning a knob on the outside of the casing.

- Single chain actuator with 2 travel positions (200mm or 380mm)
- Strong composite casing
- All electrical parts are double insulated
- High protection class IP 30 rated
- Features a robust centrally positioned double-link stainless steel chain with a buzzer alarm that sounds in the event of incorrect installation
- Supplied with 1.5m cable
- Comes complete with C30/SB standard bracket and C30/BHB bottom-hung bracket
- Available in white

### TECHNICAL DRAWINGS

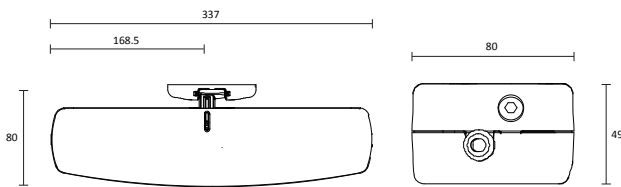

Voltage	230V AC
Stroke	200-380mm
Thrust Force	300 N
Absorbed Current	0.26A
Speed	27mm/s
Protection Class	IP 30
Flex	1.5m (3 CORE)
Limit Stop	Electronic
Safety Stop	Electronic
Max Window Width	<1.5m

### PART NUMBERS

### WINDOW TYPE



### INCLUDED BRACKETS & ACCESSORIES

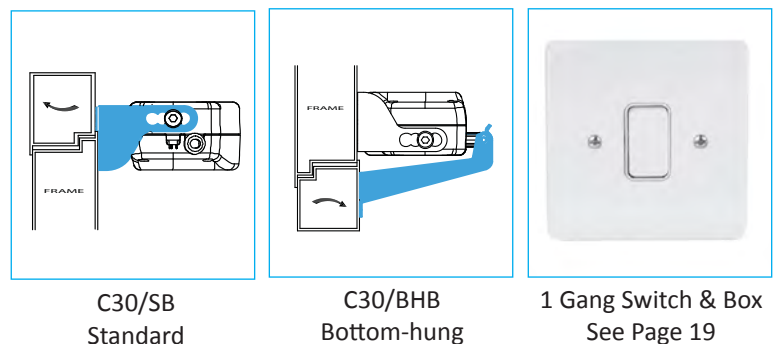

Description	Colour	Size	Part Code	Box Qty
C30 Actuator	White	337 x 80 x 49 mm	EHL10020	1

## WINDOW TYPES

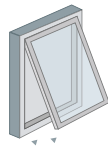

Top-hung  
Awning



Bottom-hung  
Hopper



Side-hung  
Casement

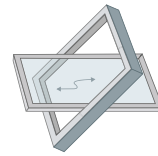

Horizontal  
Pivot



Dome

## PRODUCT INFORMATION

The Highline electric window controls range offers reliable, flexible and cost-effective systems to automate the opening of vents and high-level windows for natural ventilation. Natural ventilation improves the air quality of inside spaces by allowing clean, fresh air to enter the building while letting stale air out.

Our range of motorised single chain actuators are controllable from either a simple switch or a digital control panel with temperature, wind or rain activation. The 230V AC actuators featured in this brochure all run off standard mains electricity and are available from stock. 24V models for use in bathrooms and kitchens are also available by special order only.

Highlights of the range include the ever-popular ACK4 chain actuator (sometimes referred to as the MAC) with its 7 opening positions ranging between 100mm to 400mm and fitting brackets for most applications. Then there's the newer Micro EVO Actuator. Versatile enough to adapt to any application, it incorporates a synchronisation feature which lets you easily link several actuators together on the same window – perfect for operating wider casements.

We also have access to lots of other actuators and controls not shown in this brochure, so if you need something you can't see here, why not give our technical team a call on 01234 242724 to discuss your specific requirements.

