

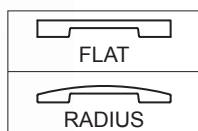

# Faceplate for LK-2100 Series Reversible Deadlatches

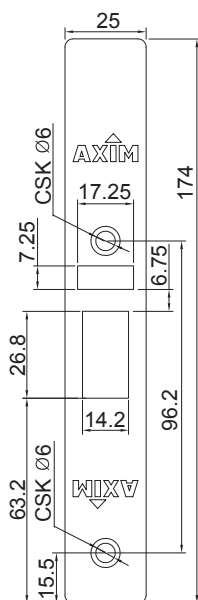

These faceplates are used with Axim's LK-2100 Series euro profile reversible deadlatches to offer flexible access control on commercial doors both during and after business hours.

- Flat or radius faceplates available
- Natural satin silver anodized finish
- Specified for use alongside the Axim ES-2200 Electric Striker
- The fixing tab kit (ALK210077 below) is recommended for use during installation
- 30-months manufacturers guarantee

## PART NUMBERS

Description	Shape	Part Code	Box Qty.
25 x 174mm	Flat Face	ALK210043	1
25 x 174mm	Radius Face	ALK210044	1

# Faceplate Fixing Tab Kit for LK-2100 Series Reversible Deadlatches

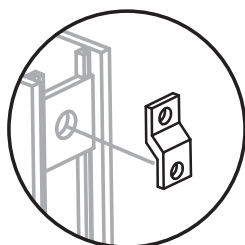

These fixing tab kits are recommended for use during installation and help to ensure the faceplate is installed firmly and securely into a euro profile door.

## PART NUMBERS

Description	To Fit	Bar Length	Box Qty.
Fixing Tab	LK-2100	ALK210077	1 pair

# Flat Strike Plate for LK-2100 Reversible Deadlatch



These flat strike plates are used with Axim's LK-2100 Series euro profile reversible deadlatches to offer flexible access control on commercial doors both during and after business hours.

- Available widths: 48mm & 72mm

## PART NUMBERS

Width	Part Code	Box Qty.
48mm	ALK216516	1
72mm	ALK217515	1

