

# Faceplate for LK-1800 Series Mortice Hook Lock

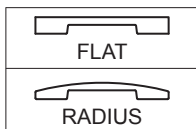

## PRODUCT INFORMATION

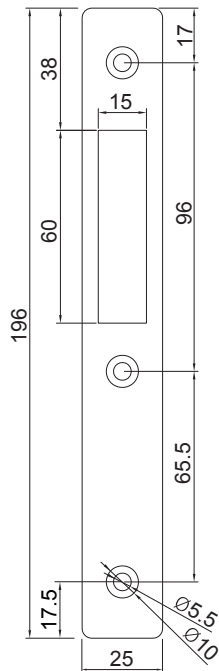

These faceplates are used with Axim's LK-1800 Series Mortice Hook Locks to deliver secure and affordable quality deadlocking on aluminium or steel commercial door installations.

- Flat or radius faceplates available
- Natural satin silver anodized finish

## PART NUMBERS

Finish	Size	Shape	Part Code	Box Qty.
Silver	196 x 25 x 2.85mm	Square	ALK18010F	1
Silver	196 x 25 x 2.85mm	Radius	ALK18010R	1

# Pair of Mounting Bridges for LK-1800 Series Mortice Hook Lock



## PRODUCT INFORMATION

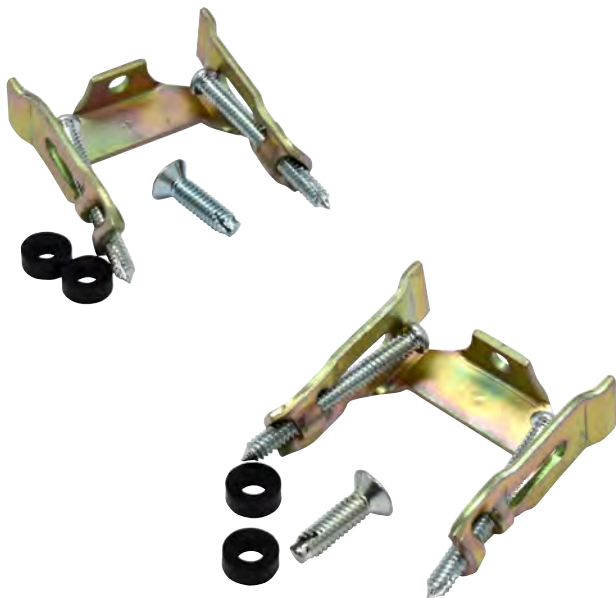

These mounting bridges are recommended for use when fitting the Axim LK-1800 mortice hook lock. They sit inside the master leaf on an aluminium door set and the main lock is screwed to them.

## PART NUMBERS

Description	Part Code	Box Qty.
Mounting Bridges	ALK181133	1 pair