

Trojan Patriot Plus Flag Hinge Fitting Details

Part number: HIN192**

Description: Trojan Patriot Plus Flag Hinge

Boxed quantity: 24



Drilling Preparation

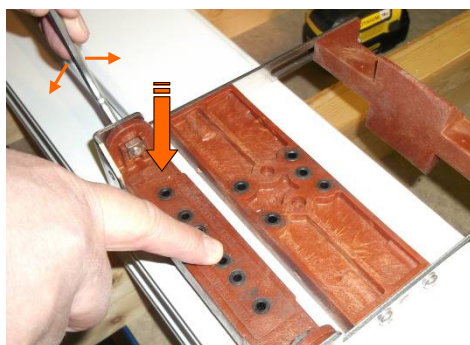

Adjust step height of jig by sliding frame block down until it sits on frame - Tighten with 5mm Allen key



Adjust grip onto sash by sliding clamp block until it sits on inner edge of sash - Tighten with 5mm Allen key



Using a $\varnothing 4.0\text{mm}$ drill bit, drill through the skin of the profile only, at the Pin Locations as shown below and as marked on jig



Shows only Location Pin Positions drilled

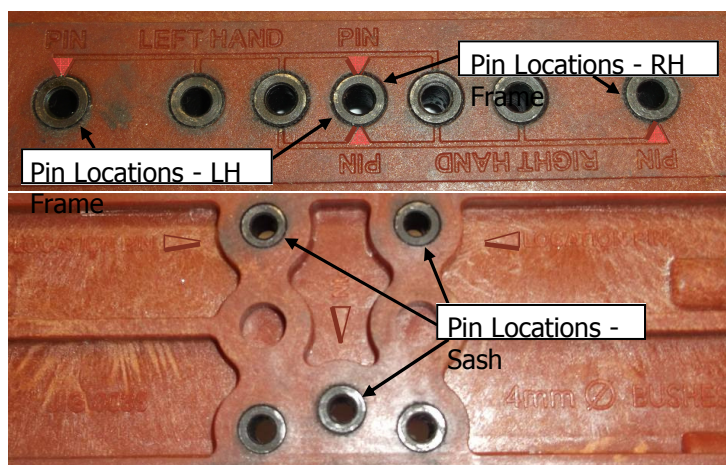

Note: only drill Left or Right Hand pin locations as required when drilling the frame side. If not using drill point screws continue to pilot the remainder of the holes as required

- Jig is symmetrical and can be used for either hand as required
- Recommended screw size $\varnothing 4.8\text{mm}$ —select suitable screw type for the reinforcing being used

Trojan Patriot Plus Flag Hinge Fitting Details

Part number: HIN192**
Description: Trojan Patriot Plus Flag Hinge
Boxed quantity: 24

**WINDOW
WARE**
We've got it



...The Strength of Hardware Design

Fitting To Frame

1

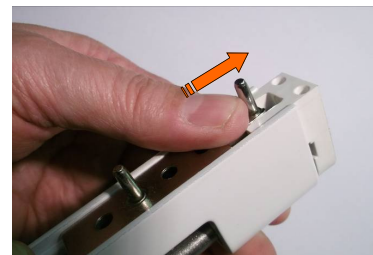

Hinge will normally be supplied unlatched. However, if it is necessary to remove Frame Mount insert flat screwdriver behind metal tang and lever towards Pivot Pin. With screw driver still in place, slide Frame Mount out as shown

2

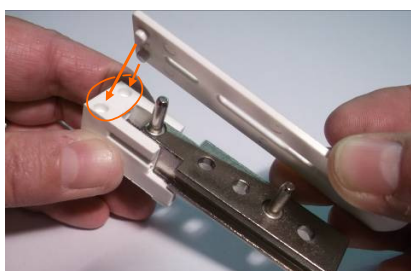

Fit shim as shown if required. Locate the 2 pins into the corresponding holes on the Frame Mount Moulding

3

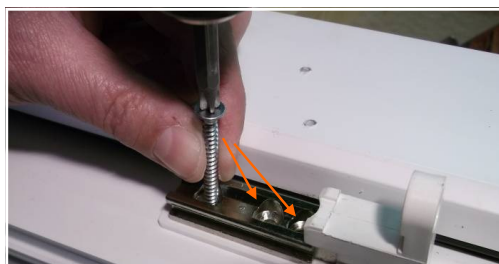
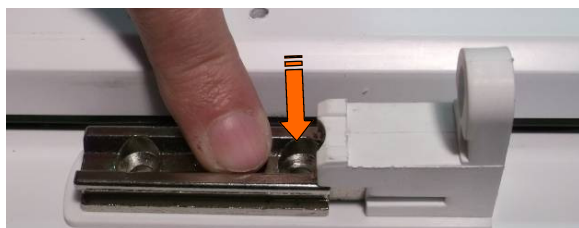

Align location pins with holes in frame, insert the pins and push the Frame Mount fully down.
Secure in place with screws in 3 places ensure screws are the correct length to engage with reinforcing

4

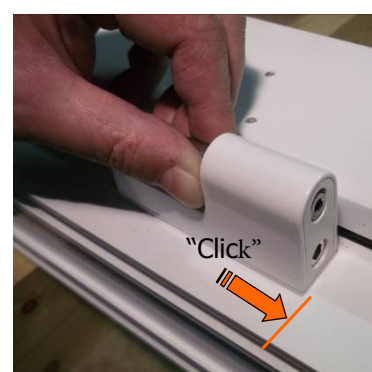

Slide Frame Body casting onto Frame Mount and push all the way down until it clicks into place and until it is flush with the bottom of the Frame Mount Moulding