



# Supa™

## Stainless Steel The Collection.

Extreme Durability • Strong •  
Fully Suited • Corrosion Resistance •  
Standard & Enhanced Security Options •

Suitable for PVCu, timber,  
aluminium & composite doors





# Supa™ Stainless Steel The Collection.

Page	Product
4	<b>Supa™ Door Handle</b> Standard security stainless steel door handle.
6	<b>SupaSecure™ Letterplate</b> High security stainless steel letterplate. TS008 certified, SBD approved.
8	<b>Supa™ Letterplate</b> Standard security stainless steel letterplate.
10	<b>Supa™ Pull Bar Collection</b> Inline, offset, bow, D, V shape stainless steel designs.
14	<b>Supa™ Door Knobs</b> 3 stainless steel finishes.
16	<b>SupaSecure™ Escutcheons</b> 2 stainless steel styles. SBD approved.
18	<b>SupaSecure™ Pull Escutcheons</b> 2 stainless steel styles. SBD approved.
20	<b>Supa™ Escutcheons</b> Standard, pull and square designs.
22	<b>Supa™ Door Knockers, Numerals and Letters</b> Stainless steel accessories.
25	<b>Supa™ Stainless Steel Collection</b> Part numbers & dimension drawings..

# Supa™ Stainless Steel Door Handle.

Mila's Supa™ door handles combine **high quality stainless steel** with **elegant, modern design**.

The Supa™ range has been independently tested **beyond industry standards** for **long-lasting** weather resistance and **high operational performance**, and is **guaranteed for 25 years**.

## Accreditations.



### Corrosion Resistance

BSEN 1670, Grade 5

Testing exceed 1000 hours salt spray



### Extreme Durability

BSEN 1906

200,000 cycles | 100kg lever pull



### Operation & Weather Tightness

BSEN 6375 - 1, 2, 3

50,000 cycles under load

## 3 SUPA™ Stainless Steel Finishes.



Brushed Stainless



Polished Stainless



Polished Gold PVD Stainless

Available in lever/lever and lever/pad designs.

Blank backplate options available. See page 30 for order details.

# Elegant Design.



## Durable

Manufactured from high quality stainless steel, available in grade 304 & 316

## Stylish

Simply designed for a modern aesthetic

## Ergonomic

A sprung lever ensures consistent return to 90° to avoid 'handle sag'

## Easy Installation

Universal design for both left and right handed doors. 240mm backplate suits most popular lock sizes. Supplied complete with screws



# SupaSecure™ TS008 Letterplate.

Mila's SupaSecure™ high security letterplate is TS008 certified, Secured by Design approved, BSI Kitemarked, ADQ compliant and meets the requirements of the Postal Services Standard BSEN 13724.

High quality stainless steel combines with clever security technology for extreme strength and durability and long-lasting operational performance.

For extreme weather tightness the Supa™ letterplate has been tested to BS6375-1 resisting 150 Pascals air pressure while preventing water ingress applied at 2 litres per minute under gale force wind conditions.

Independently tested to the toughest industry standards and guaranteed for 25 years.

## Accreditations.



**Secured By Design**  
Official Police Security Initiative  
**MILA**



**BSI Kitemark**  
Laser etched onto internal letterplate for homeowner peace of mind



**Enhanced Security**  
PAS24: 2016



**Letterplate Security**  
TS008 Certified  
20,000 cycles & 100kg flap pull test



**Corrosion Resistance**  
BSEN 1670, Grade 5  
Over 1000 hours salt spray



**Extreme Tested**  
BS 6375-1



**Approved Document Q**  
Certified



**Postal Services Standard**  
BSEN 13724: 2013  
to ensure 'delivery in good condition' of postal items

## 6 SUPA™ Stainless Steel Finishes.



Brushed Stainless



Brushed Gold PVD  
Stainless



Polished Stainless



Polished Gold PVD Stainless



Black Powder Coated  
Stainless



White Powder Coated  
Stainless



# Intelligent Design.

## ANTI-FISHING TECHNOLOGY

Our patented anti-fishing fins operate with a smooth concertina action for clever, secure, restricted flap opening and a compact aesthetic



### Slim

Compact internal side projects just 45mm discreet and allows the door to fully open

### Durable

Manufactured from high quality stainless steel, grade 304

### Beautiful

Concealed flap-operating mechanism for seamless design

### Standard Size

Fits door thicknesses 40 - 80mm

### Fishing Deflection

Angled postal ramp deflects items upwards

### Extreme

Achieved 100kg flap pull test for super-strong enhanced security

### Secure

Restricted opening angle of 80° is accessible and secure

### Coordinated

Matching stainless steel frame and flap

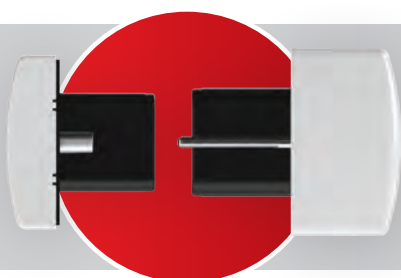

### Installed in less than 2 minutes

Ready to fit - straight from the box to the door in 1 piece

Standard aperture - no special fixings or routing



# Supa™ Stainless Steel Letterplate.

Mila's Supa™ letterplate is manufactured from **high quality stainless steel**. The **contemporary design** features a **matching frame and flap**, and suites with other **Supa™** stainless steel door furniture for a **fully coordinated** look.

The range has been independently tested to the toughest **performance** standards including **durability tested to clause 6.8 of TS008: 2015** achieving 20,000 cycles, BSEN 1670 achieving the highest grade 5 rating for corrosion resistance. In fact, the SUPA™ stainless steel letterplate has been tested to twice the industry standard requirement achieving 1000 hours in a salt spray chamber.

For **extreme weather tightness** the Supa™ letterplate has been tested to **BS6375-1** resisting 150 Pascals air pressure while preventing water ingress applied at 2 litres per minute under gale force wind conditions.

Supa™ standard letterplates are **guaranteed for 25 years** for both mechanical operation and surface finish.

## Accreditations.



### Corrosion Resistance

BSEN 1670, Grade 5  
Over 1000 hours salt spray



### Extreme Weather Tightness

BS 6375-1



### Operational Durability

Clause 6.8 of TS008  
20,000 cycles

## 4 SUPA™ Stainless Steel Finishes.



Brushed Stainless



Brushed Gold PVD  
Stainless



Polished Stainless



Polished Gold PVD  
Stainless



# Contemporary Design.

## Coordinated

Matching stainless steel frame and flap

## Intelligent

Flap opens fully to 180° without abrasion

## Durable

Manufactured from high quality stainless steel, grade 304

## Ergonomic

Finger recesses both internally and externally enable easy opening

## Sleek

Concealed flap-operating mechanism for seamless design

## Universal

Fits door thicknesses 24mm-56mm



# Supa™ Stainless Steel Pull Bars.

Mila's Supa™ pull bars combine **high quality stainless steel** and **contemporary styling**.

The range is available in **2 modern designs** - inline and offset - and is available in 8 lengths from 400mm up to 1800mm. The off-set design is available in 45° and 60° angles to suit slimmer profile systems.

The pull bars range is **simple to install**, with **3 fixing kit options** available.

Finally, Mila's Supa™ stainless steel pull bars have been independently tested to BSEN 1670 achieving the **highest grade 5 rating** for **corrosion resistance**. In fact, the range has been tested to **twice** the industry standard requirement achieving **1000 hours** in a salt spray chamber for a **durable, long-lasting finish, guaranteed for 25 years**.



## Accreditations.



**Corrosion Resistance**  
BSEN 1670, Grade 5



# Modern Design.

## High Quality Finish

Brushed stainless steel, grade 304

## 3 Fixing Options

Through fix, concealed fix or back-to-back

## 2 Styles

Inline or Offset

## 8 Lengths

400mm, 600mm, 800mm, 1000mm, 1200mm,  
1400mm, 1600mm, 1800mm

## Universal

Suitable for both left and right-handed doors

Choose your  
Fixing Kit Option  
P.33



# Supa™ Stainless Steel Curved Pull Bars.

Mila's Supa™ curved pull bars combine **high quality stainless steel** and **contemporary styling**.

The range is available in **3 curved designs**: Bow, D and V shapes.

The pull bars range is **simple to install**, with **3 fixing kit options** available.

Finally, Mila's Supa™ stainless steel curved pull bars have been independently tested to BSEN 1670 achieving the **highest grade 5 rating** for **corrosion resistance**. In fact, the range has been tested to **twice** the industry standard requirement achieving **1000 hours** in a salt spray chamber for a **durable, long-lasting finish, guaranteed for 25 years**.

## Accreditations.



**Corrosion Resistance**  
BSEN 1670, Grade 5

**Supa Bow**  
588mm



# Super Shapes.

## High Quality Finish

Brushed stainless steel, grade 304

## 3 Fixing Options

Through fix, concealed fix  
or back-to-back

*Choose your  
Fixing Kit Option  
P.33*

## Universal

Suitable for both left and right handed doors

## 3 Styles

Bow, V and D shapes



## Supa V

330mm



## Supa D

330mm





# Supa™ Stainless Steel Door Knobs.

Mila's Supa™ door knobs combine **high quality stainless steel** and **elegant styling**.

The range is available in **3 stainless steel finishes**: brushed stainless steel, duo stainless steel combining a polished rose with a brushed knob, and duo gold PVD stainless steel combining a polished rose with a brushed knob.

Supa door knobs come complete with a **bolt-through fixing kit**, making **installation simple**.

Finally, Mila's Supa™ stainless steel door knobs have been independently tested to BSEN 1670 achieving the **highest grade 5 rating for corrosion resistance**. In fact, the range has been tested to **twice** the industry standard requirement achieving **1000 hours** in a salt spray chamber for a **durable, long-lasting finish, guaranteed for 25 years**.

## Accreditations.



**Corrosion Resistance**  
BSEN 1670, Grade 5



Brushed Stainless Steel



Duo Stainless - Polished Rose and  
Brushed Knob



Duo Gold PVD Stainless - Polished Rose and  
Brushed Knob



# Simple Style.

## High Quality

Stainless steel, grade 304

## Universal

Suitable for both left and right handed doors



# SupaSecure™ 2 Star Escutcheons.

Mila's SupaSecure™ escutcheons combine **high quality stainless steel** with **clever security technology** for market-leading **protection**, extreme **strength and durability** and long-lasting **operational performance**.

The range has been independently tested to the toughest industry standards including extreme, **heavy duty testing** to **BSEN 1906**, is **Secured by Design** approved, **BSI Kitemarked**, **ADQ compliant**, **TS007 certified** and is **guaranteed for 25 years**.

## Accreditations.



**Secured By Design**  
Official Police Security Initiative  
**MILA**



KM735758

**BSI Kitemark**  
2 Star Security



**Enhanced Security**  
PAS24: 2016



**Cylinder Enhanced Security**  
TS007 Certified



**Corrosion Resistance**  
BSEN 1670, Grade 5  
1000 hours salt spray



**Weather Tightness**  
BS 6375



**Approved Document Q**  
Certified

## 3 SUPA™ Stainless Steel Finishes.



Brushed Stainless

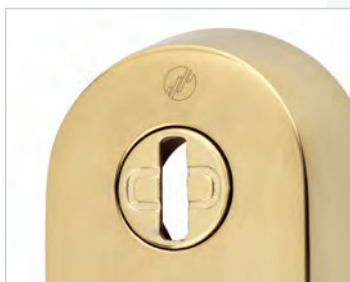

Polished Gold PVD Stainless



Polished Stainless

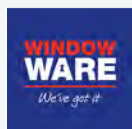



# Clever Details.

## Deterrent

SBD logo laser etched onto external escutcheon,  
BSI Kitemark etched onto internal escutcheon

## Durable

Cast stainless steel, grade 304, provides  
strength and a long-lasting finish

## Clever

Chamfered shoulders provide  
mole-grip resistance

## Protected

Anti-drill disc spins if attacked to provide  
complete cylinder protection







### **Deterrent**

SBD logo laser etched onto external escutcheon,  
BSI Kitemark etched onto internal escutcheon

### **Durable**

Cast stainless steel, grade 304, provides  
strength and a long-lasting finish

### **Clever**

Chamfered shoulders provide  
mole-grip resistance

### **Protected**

Anti-drill disc spins if attacked to provide  
complete cylinder protection

# SupaSecure™ 2 Star Pull Escutcheons.

Mila's SupaSecure™ pull escutcheons combine high quality stainless steel with clever security technology for market-leading protection, extreme strength and durability and long-lasting operational performance.

The range has been independently tested to the toughest industry standards and is Secured by Design approved, BSI Kitemarked, ADQ compliant, TS007 certified and is guaranteed for 25 years.

## Accreditations.



**Secured By Design**  
Official Police Security Initiative  



**BSI Kitemark**  
2 Star Security



**Enhanced Security**  
PAS24: 2016



**Cylinder Enhanced Security**  
TS007 Certified



**Corrosion Resistant**  
BSEN 1670, Grade 5  
1000 hours salt spray



**Weather Tightness**  
BS 6375



**Approved Document Q**  
Certified

## 3 SUPA™ Stainless Steel Finishes.



Brushed Stainless

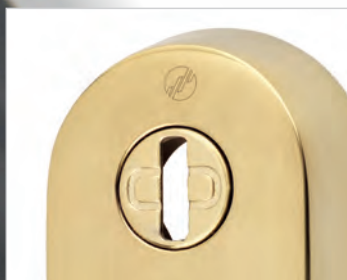

Polished Gold PVD Stainless



Polished Stainless



# Supa™ Stainless Steel Escutcheons.

Mila's Supa™ standard escutcheon range combines **high quality stainless steel** and **elegant styling**.

The range is available in **2 designs** - standard and standard pull. **Three stainless steel finishes** include brushed stainless steel, polished stainless steel and polished gold PVD stainless steel.

Supa™ escutcheons are **simple to install** and some feature concealed fixings.

Finally, all of Mila's Supa™ stainless steel escutcheons have been independently tested to BSEN 1670 achieving the **highest grade 5 rating** for **corrosion resistance**. In fact, the range has been tested to **twice** the industry standard requirement achieving **1000 hours** in a salt spray chamber for a **durable, long-lasting finish, guaranteed for 25 years**.



## Accreditations.



**Corrosion Resistance**  
BSEN 1670, Grade 5

## 3 SUPA™ Stainless Steel Finishes.



Brushed Stainless



Polished Gold PVD Stainless



Polished Stainless

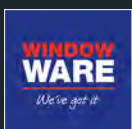



# Small, Important Details.



Standard  
Escutcheon

## High Quality Finishes

Grade 304

## 3 Designs

Standard, pull and square

## Universal

Suitable for both left and right handed doors

## Concealed Fixing

The stainless steel clip-fit cover, conceals fixings in a sturdy nylon bracket (standard & square escutcheons only)



Standard Pull  
Escutcheon

# Supa™ Stainless Steel Accessories.

Mila's Supa™ stainless steel door knockers, letters and numerals combine **high quality stainless steel** and **elegant styling**.

Door knockers are available in **4 stainless steel finishes**: brushed stainless steel, polished stainless steel, brushed gold PVD stainless steel and polished gold stainless steel.

All of Mila's Supa™ stainless steel door accessories have been independently tested to BSEN 1670 achieving the **highest grade 5 rating** for **corrosion resistance**. In fact, the range has been tested to **twice** the industry standard requirement achieving **1000 hours** in a salt spray chamber for a **durable, long-lasting finish, guaranteed for 25 years**.

## Accreditations.



**Corrosion Resistance**  
BSEN 1670, Grade 5



## High Quality Finishes

Letters & numerals in grade  
304 & 316 stainless steel

## 4 SUPA™ Stainless Steel Finishes.

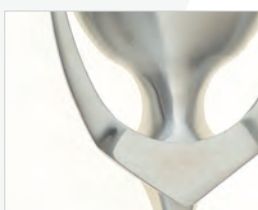

Brushed Stainless

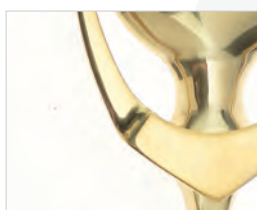

Brushed Gold PVD Stainless

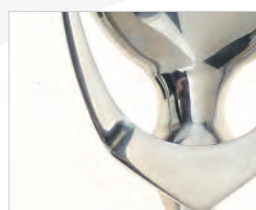

Polished Stainless



Polished Gold PVD Stainless

# Make an Entrance.



## High Quality Finishes

Knockers in grade 304 stainless steel

## 2 Knocker Designs

With & without hole, concealed or through fix



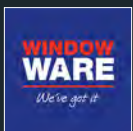

# Supa™ Stainless Steel

## Part Numbers & Dimensional Drawings.

Page	Product
26	Supa™ Door Handle
27	ProLinea Door Handle
28	SupaSecure™ Letterplate
29	Supa™ Letterplate
30	Supa™ Pull Bar Collection
31	Supa™ Curved Pull Bars
32	Supa™ Door Knobs
33	Supa™ Pull Bar Fixing Kit
34	Supa™ Pull Bar Fitting Instructions
36	SupaSecure™ Escutcheons
37	Supa™ Escutcheons
38	Supa™ Door Knockers
39	Supa™ Numerals & Letters

# Supa™ Stainless Steel Door Handles

Part numbers & dimensional drawings.

Description	Grade	Variant	Backplate	PZ	Polished Stainless	Brushed Stainless	Polished Gold PVD Stainless
Supa™ Standard Door Handle	304	Lever/Lever	240mm	92	HDL56511	HDL53511	HDL59511
Supa™ Standard Door Handle	304	Lever/Lever	240mm	92/62	HDL56531	HDL53531	HDL59531

Note. 316 grade stainless steel available to special order - please contact the Window Ware sales team for further information on 01234 242724

Supplied complete with screws

92PZ

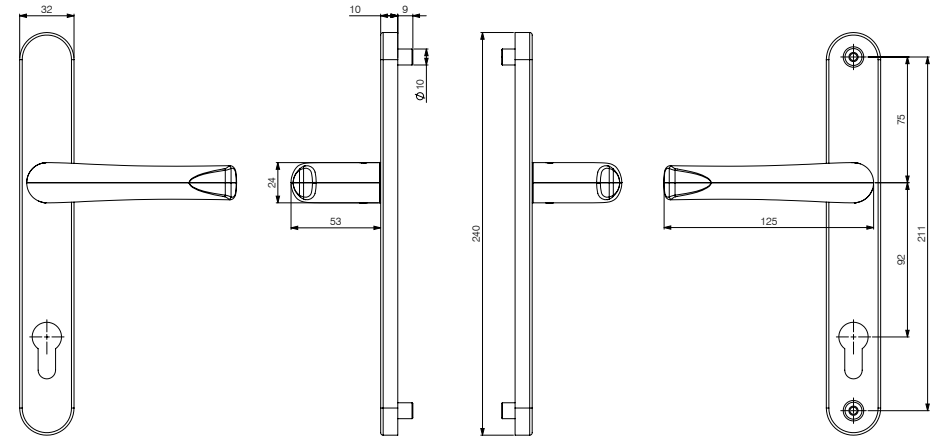

92/62PZ

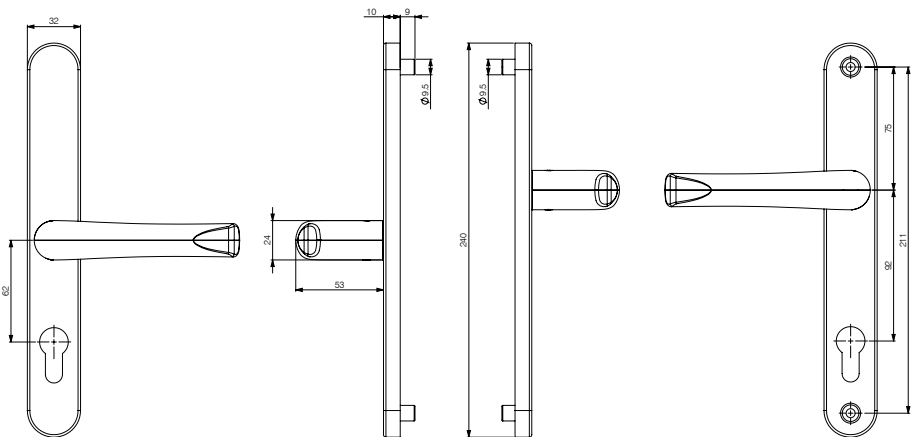



# ProLinea Door Handles

## Part numbers & dimensional drawings.

Description	Variant	Backplate	PZ	White	Black	Anthracite Grey
ProLinea Standard Door Handle	Lever/Lever	240mm	92	HDL50511	HDL55511	HDL54511
ProLinea Standard Door Handle	Lever/Lever	240mm	92/62	HDL50531	HDL55531	-

Supplied complete with screws

92PZ

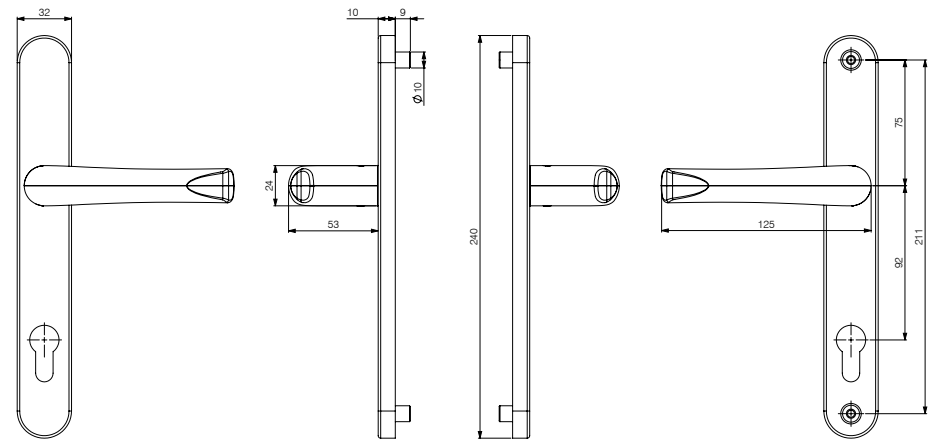

92/62PZ

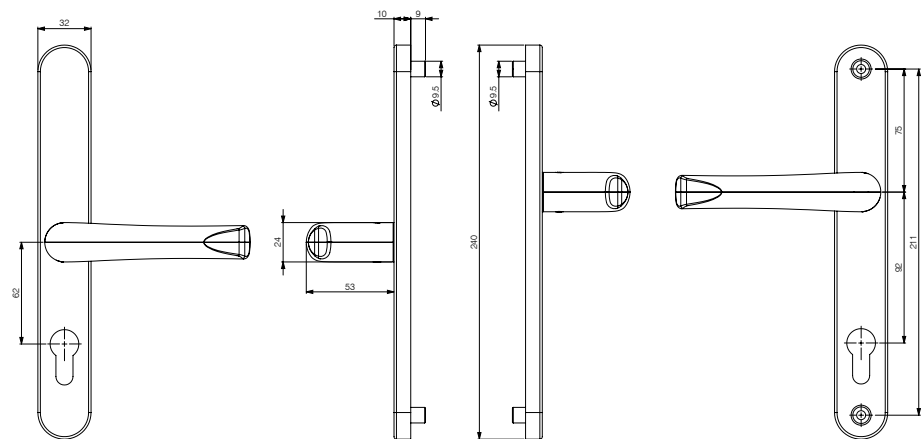

# SupaSecure™ TS008 Letterplates

## Part numbers & dimensional drawings.

Description	Grade	External Letterplate Polished Stainless	External Letterplate Brushed Stainless	External Letterplate Polished Gold PVD Stainless	External Letterplate Black Powder Coated Stainless	External Letterplate White Powder Coated Stainless
Internal TS008 Letterplate Black	304	-	-	-	MLP51005	-
Internal TS008 Letterplate White	304	MLP51006	MLP51003	MLP51009	-	MLP51000

Note. Additional colour combinations available - please contact the Window Ware sales team on 01234 242724

Supplied complete with screws

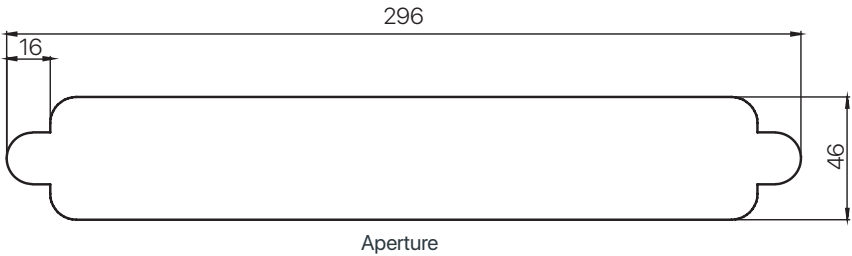
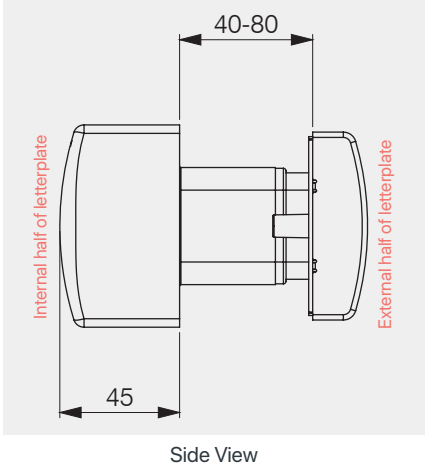
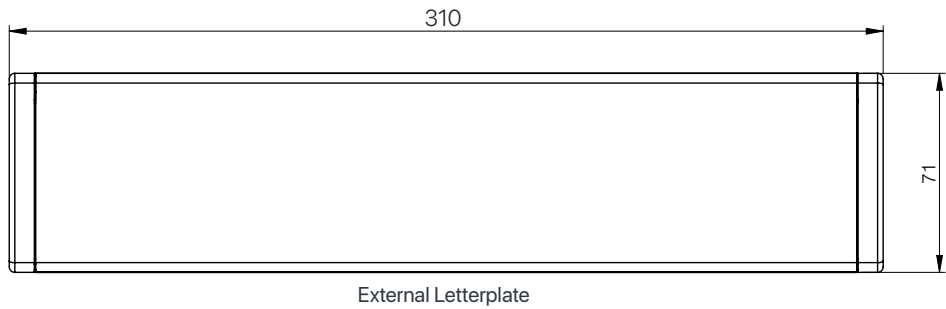
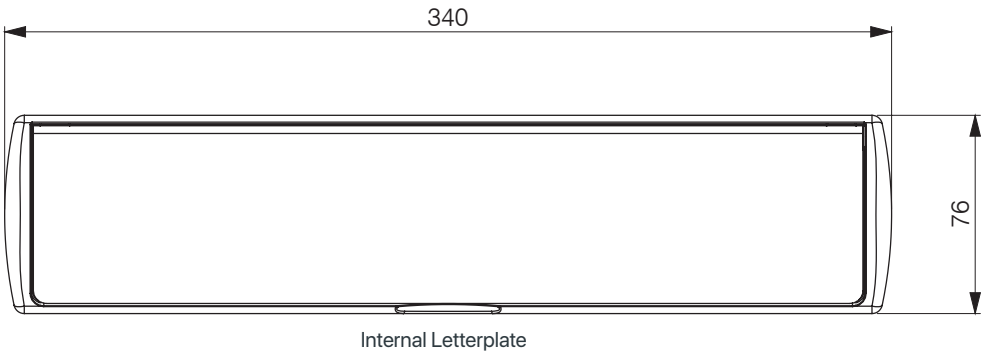

# Supa™ Stainless Steel Letterplates

## Part numbers & dimensional drawings.

Description	Grade	Polished Stainless	Brushed Stainless	Polished Gold PVD Stainless	Black Powder Coated Stainless	White Stainless
Supa™ Standard Letterplate	304	MLP50006	MLP50003	MLP50009	MLP50005	MLP50000

Supplied complete with screws

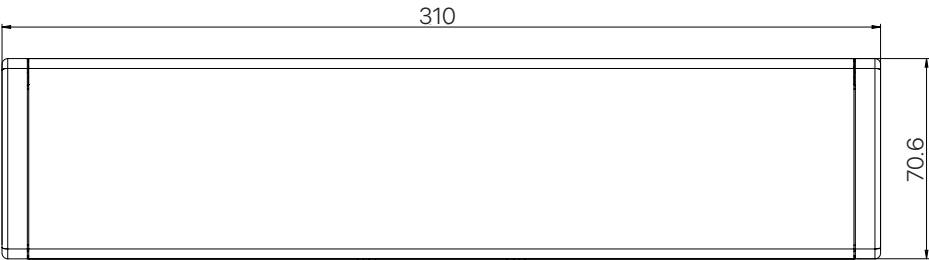

Internal Letterplate

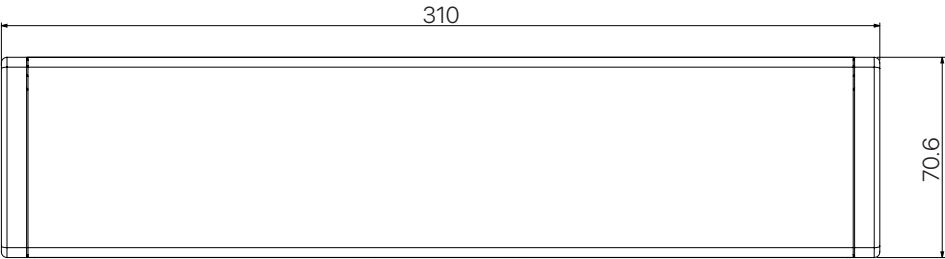

External Letterplate

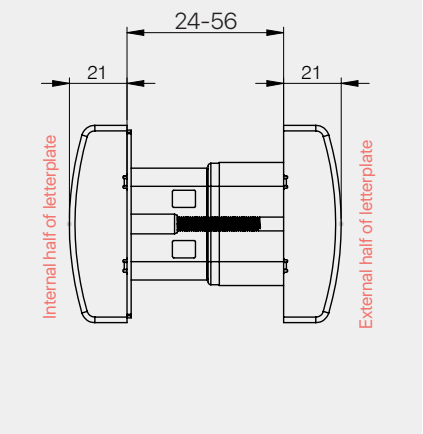

Side View

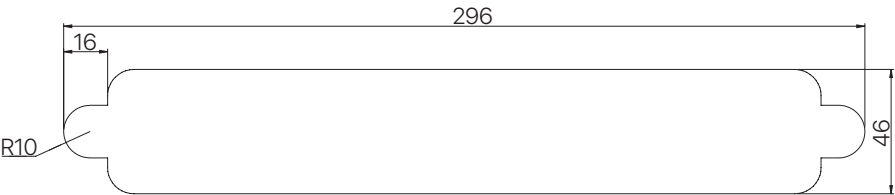

Aperture

# Supa™ Stainless Steel Pull Bars



## Part numbers & dimensional drawings.

Description	Variant	Grade	Brushed Stainless 400mm	Brushed Stainless 600mm	Brushed Stainless 800mm	Brushed Stainless 1000mm	Brushed Stainless 1200mm	Brushed Stainless 1400mm	Brushed Stainless 1600mm	Brushed Stainless 1800mm
Supa™ Pull Bar	Offset 60°	304	MPH573002	MPH573012	MPH573022	MPH573032	MPH573042	MPH573052	MPH573062	MPH573072
Supa™ Pull Bar	Inline	304	MPH573102	MPH573112	MPH573122	MPH573132	MPH573142	MPH573152	MPH573162	MPH573172

Fixing kit required - see page 33 for details

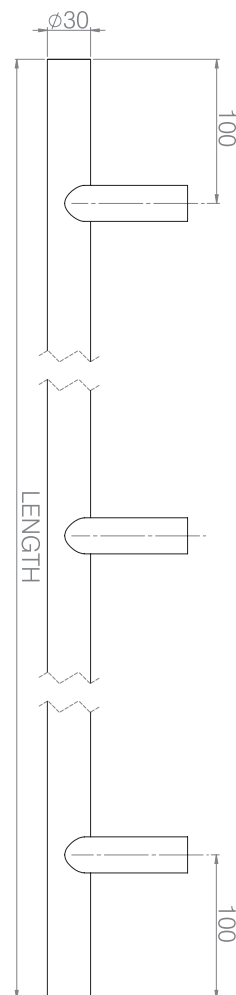
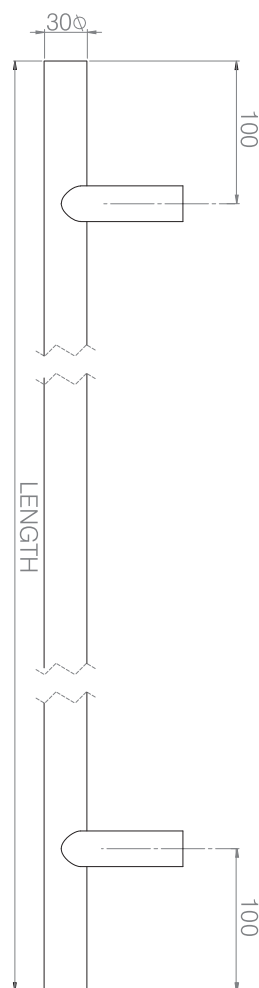
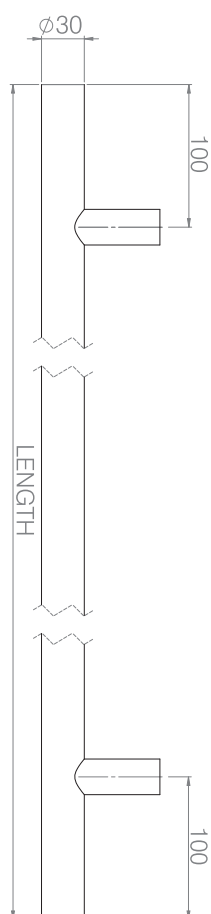
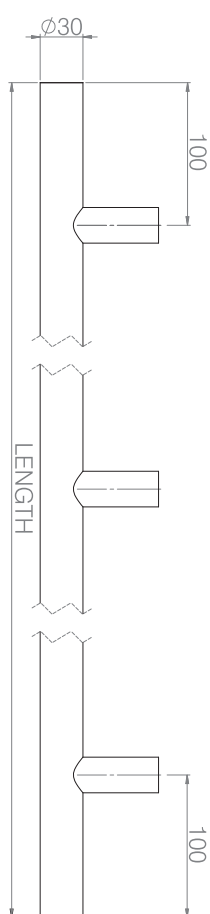

Inline

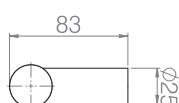
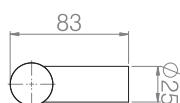

Offset

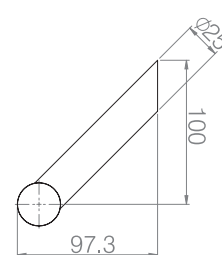
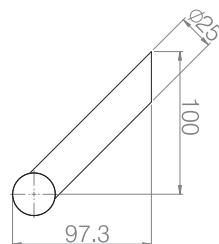

# Supa™ Stainless Steel Curved Pull Bars

Part numbers & dimensional drawings.

Description	Variant	Grade	Overall Length	Fixing Centers	Fixing Points	Brushed Stainless
Supa™ Curved Pull Bar	D	304	330mm	300mm	2	MPH573202
Supa™ Curved Pull Bar	V	304	330mm	300mm	2	MPH573212
Supa™ Curved Pull Bar	Bow	304	587mm	500mm	2	MPH573222

Fixing kit required - see page 33 for details

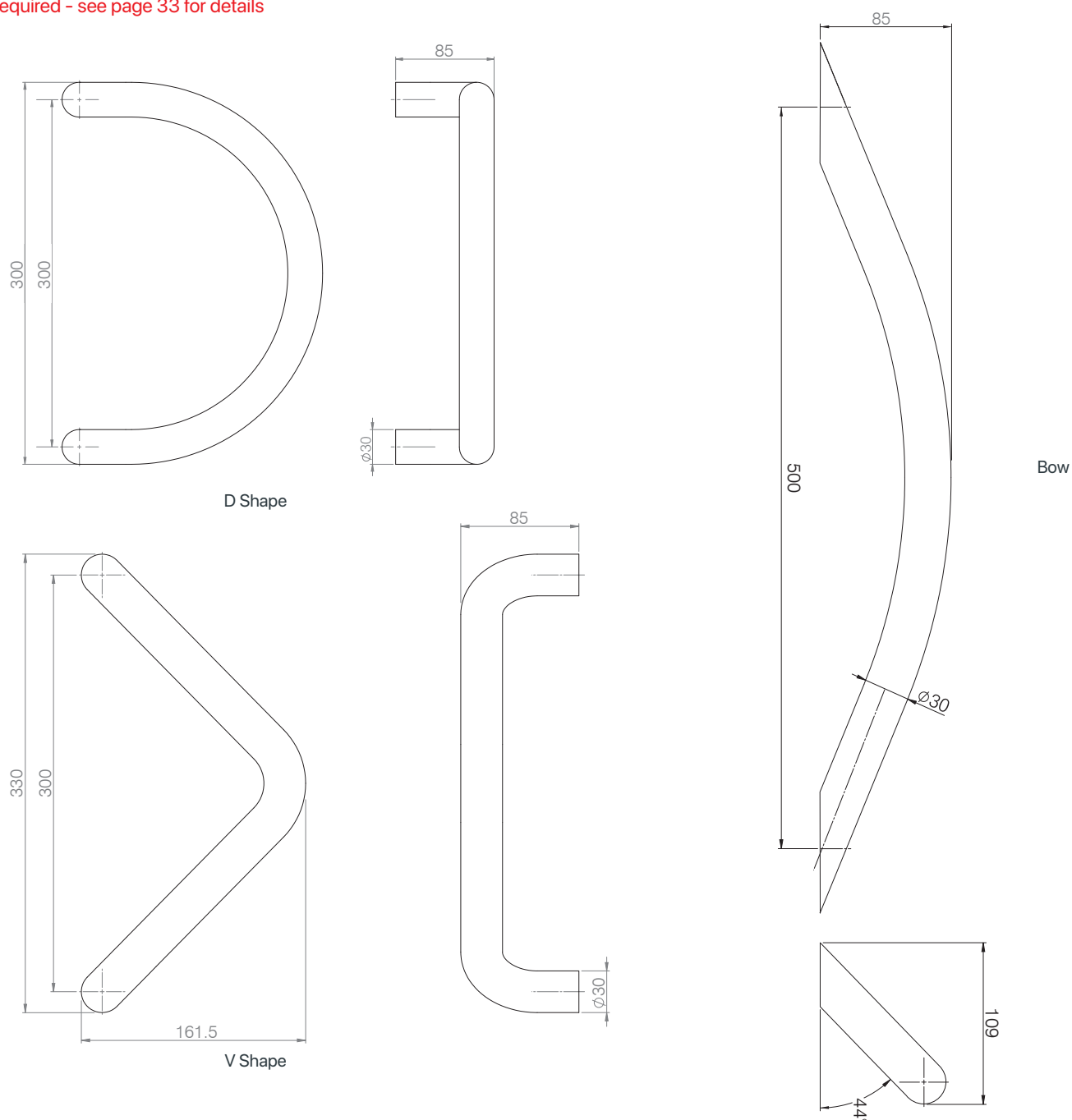

# Supa™ Stainless Steel Door Knobs

Part numbers & dimensional drawings.

Description	Variant	Grade	Brushed Stainless
Supa™ Door Knob	Through Fix	304	MPH574002

Through fixing kit included - see page 33 for details

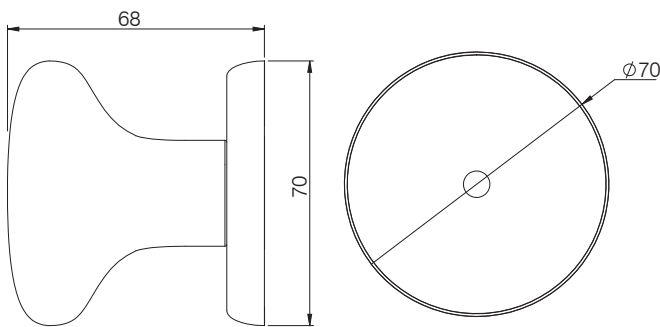



# Supa™ Stainless Steel Fixing Kits

## Part numbers

Description	Type	Grade	Part Number
Supa™ Pull Bar Fixing Kit	Through	304	MPH573302
Supa™ Pull Bar Fixing Kit	Concealed	304	MPH573320
Supa™ Pull Bar Fixing Kit	Back-to-back, 44mm - 56mm slab	304	MPH573315
Supa™ Pull Bar Fixing Kit	Back-to-back, 64mm - 76mm slab	304	MPH573316

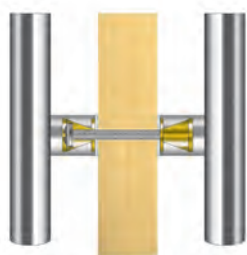

Back-to-Back Fixing

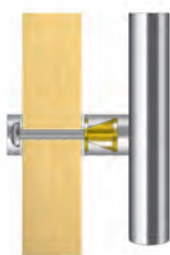

Through Fixing

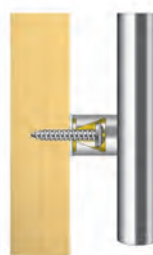

Concealed Fixing

*See Fixing Kit  
Instructions  
Overleaf*

# Supa™ Simple Pull Bar Installation.

## Back-to-back installation

400mm - 1200mm pull bars have 2 fixing points

1400mm - 1800mm pull bars have 3 fixing points and require an additional fixing pack

**Important.** Choose the fixing location on you door carefully to ensure sufficient gearbox and cylinder clearance.

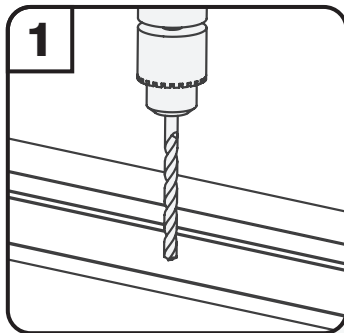
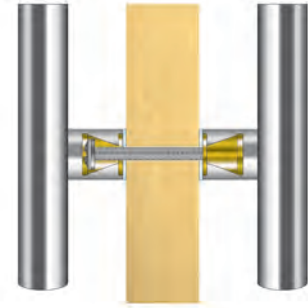

Drill an 8mm hole into the door at the required locations.

For accuracy, measure and mark both sides of the door.

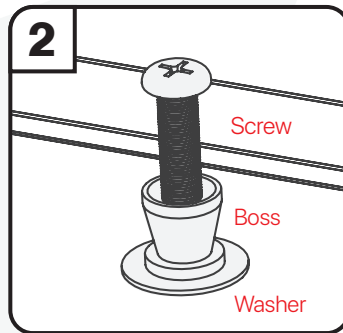

*From the internal side of the door;*

Slide a non-threaded boss (flat base towards the door) onto the M8 screw, followed by a clear plastic washer. Locate onto door, into one of drilled holes.

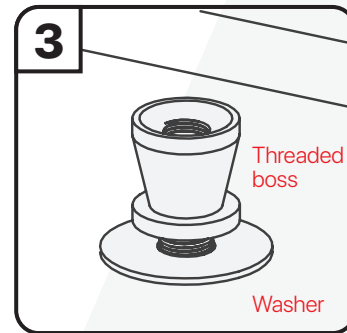

*From the external side of the door;*

Position a plastic washer over the screw followed by the threaded boss (flat base against the door) and tighten with PH3 screwdriver - do not over tighten. Repeat for remaining fixings positions.

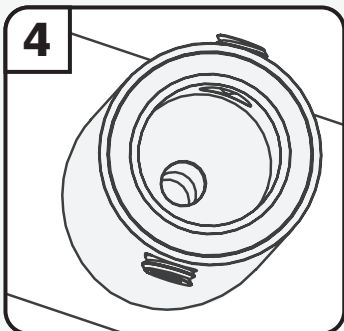

On the pull bar; ensure grub screws are fully out before fitting over boss.

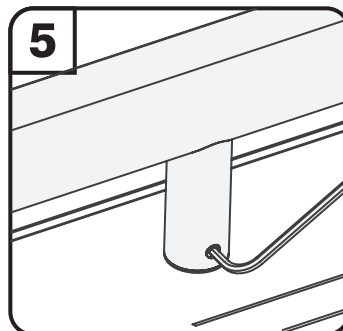

Locate pull bar over the boss, tighten both grub screws on both to secure.

# Fixing Kit Guide.

## Through & Concealed installation

400mm - 1200mm pull bars have 2 fixing points

1400mm - 1800mm pull bars have 3 fixing points and require an additional fixing pack

**Important.** Choose the fixing location on your door carefully to ensure sufficient gearbox and cylinder clearance

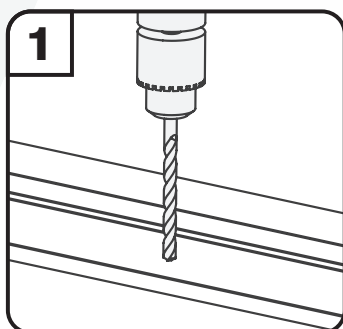
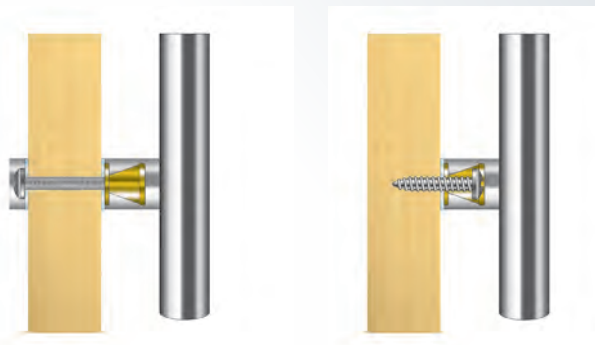

Drill an 8mm hole into the door at the required locations.

Through fix - for accuracy, measure and mark both sides of the door.

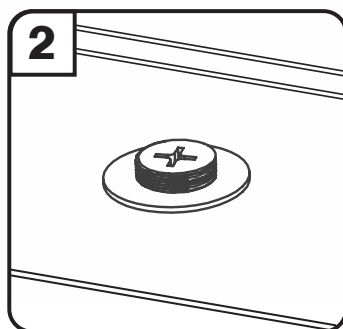

Through fix: *from the internal side of the door*, slide a clear plastic washer onto the M8 screw and locate onto door, into one of drilled holes.

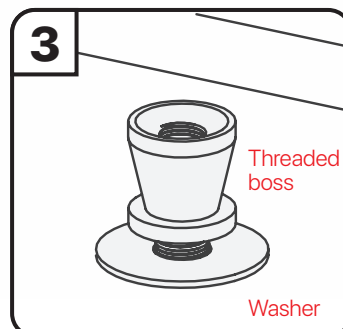

Through fix: *From the external side of the door*, position a plastic washer over the screw followed by threaded boss (flat base against door)

Concealed fix: *From the external side of the door*, thread the screw through the boss and a washer and locate the flat base against door.

Tighten with PH3 screwdriver - do not over tighten. Repeat for remaining fixings positions.

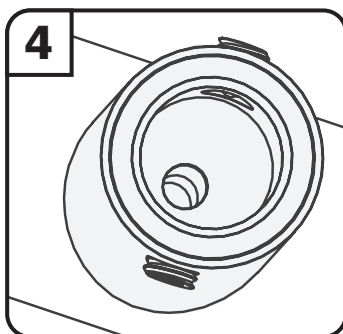

On the pull bar; ensure grub screws are fully out before fitting over boss.

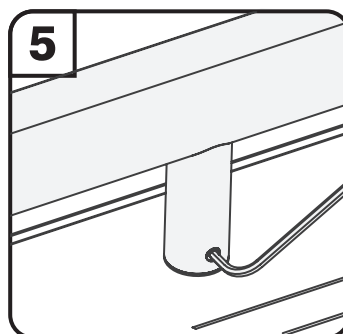

Locate pull bar over the boss, tighten both grub screws on both to secure.

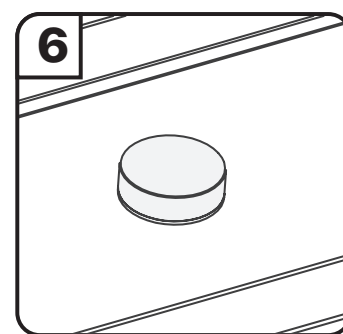

Through fix: *from the internal side of the door*; screw disc over screw and washer.

# SupaSecure™ 2 Star Escutcheons

## Part numbers & dimensional drawings.

Description	Grade	Polished Stainless	Brushed Stainless	Polished Gold PVD Stainless
SupaSecure™ Escutcheon	304	-	ESC50001	-
SupaSecure™ Pull Escutcheon	304	ESC51002	ESC51001	ESC51008

Supplied complete with screws

SupaSecure™ Escutcheon

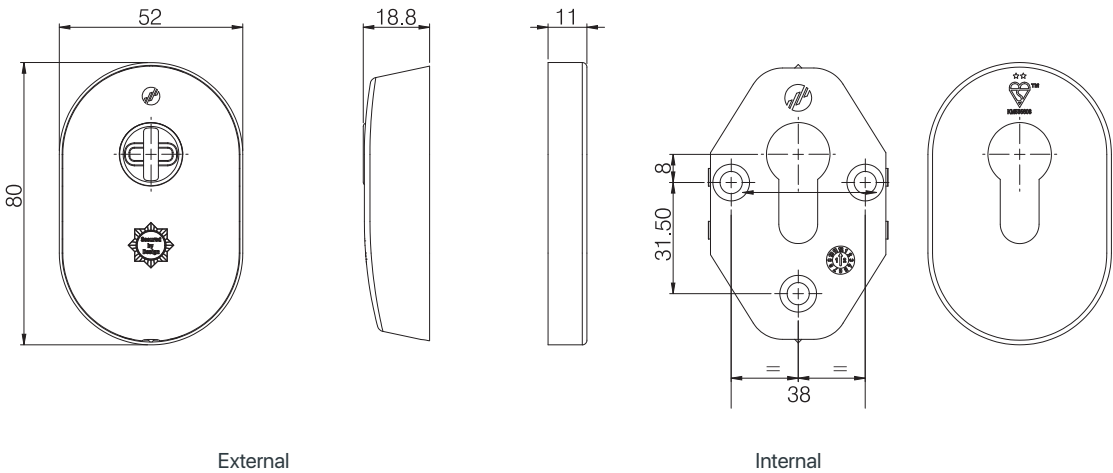

SupaSecure™ Pull Escutcheon

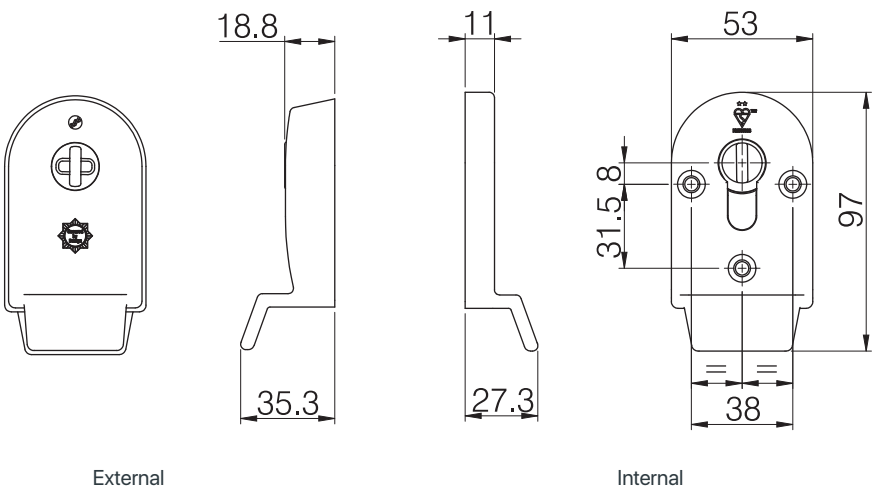

# Supa™ Stainless Steel Escutcheons

Part numbers & dimensional drawings.

Description	Grade	Polished Stainless	Brushed Stainless	Polished Gold PVD Stainless
Supa™ Standard Escutcheon	304	-	ESC53001	-
Supa™ Pull Escutcheon	304	ESC52002	ESC52001	ESC52008

Supplied complete with screws

Supa™ Standard Escutcheon

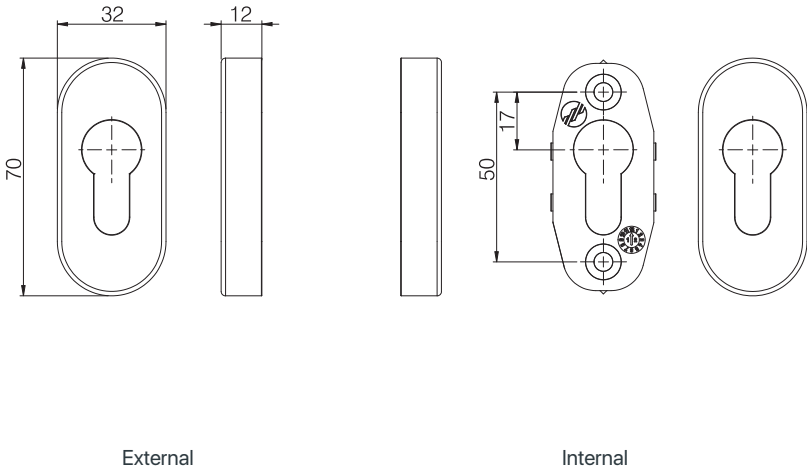

Supa™ Pull Escutcheon

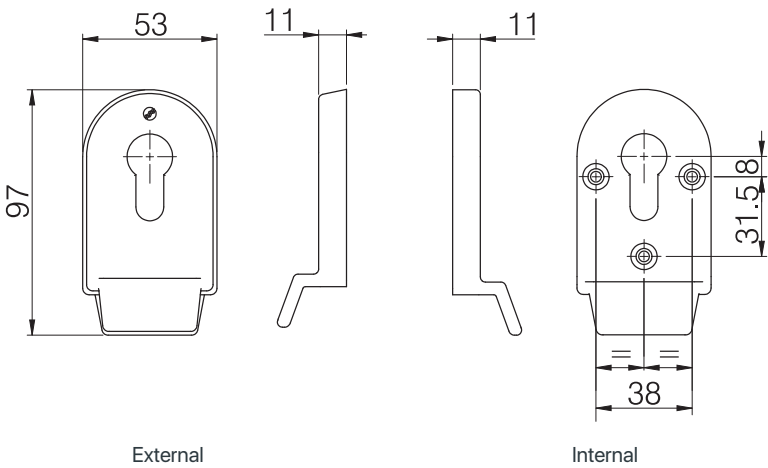

# Supa™ Stainless Steel Door Knockers

Part numbers & dimensional drawings.

Description	Grade	Size	Fixing	Polished Stainless	Brushed Stainless	Polished Gold PVD Stainless
Supa™ Urn Kocker	304	6"	Concealed	KNK50016	KNK50013	KNK50019

Supa™ Urn Kocker with hole	304	6"	Concealed	KNK50006	KNK50003	KNK50009
----------------------------	-----	----	-----------	----------	----------	----------

Supplied complete with concealed fixings

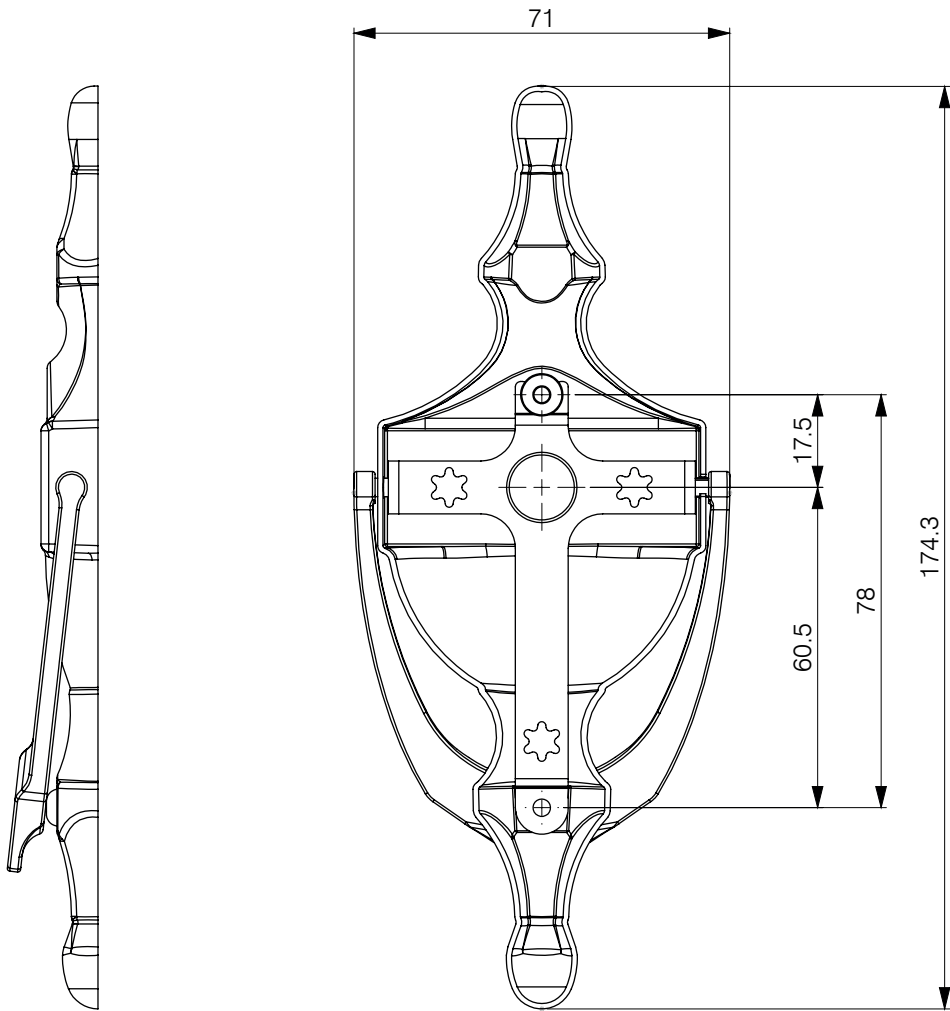

# Supa™ Stainless Steel

## Numerals & Letters

Part numbers.

Description	Number	Polished Stainless Grade 304	Brushed Stainless Grade 316	Polished Gold PVD Stainless Grade 304
Supa™ Number	0	NUM50600	NUM50300	NUM50900
Supa™ Number	1	NUM50601	NUM50301	NUM50901
Supa™ Number	2	NUM50602	NUM50302	NUM50902
Supa™ Number	3	NUM50603	NUM50303	NUM50903
Supa™ Number	4	NUM50604	NUM50304	NUM50904
Supa™ Number	5	NUM50605	NUM50305	NUM50905
Supa™ Number	6	NUM50606	NUM50306	NUM50906
Supa™ Number	7	NUM50607	NUM50307	NUM50907
Supa™ Number	8	NUM50608	NUM50308	NUM50908
Supa™ Number	9	NUM50609	NUM50309	NUM50909
Supa™ Letter	A	LET50600A	LET50300A	LET50900A
Supa™ Letter	B	LET50600B	LET50300B	LET50900B
Supa™ Letter	C	LET50600C	LET50300C	LET50900C
Supa™ Letter	D	LET50600D	LET50300D	LET50900D
Supa™ Letter	E	LET50600E	LET50300E	LET50900E
Supa™ Letter	F	LET50600F	LET50300F	LET50900F

Supplied complete with screws

available from



01234 242724 | [www.windowware.co.uk](http://www.windowware.co.uk)

[sales@windowware.co.uk](mailto:sales@windowware.co.uk)



## Care & Maintenance

We recommend that you regularly maintain your stainless steel hardware for optimum performance.

Download our Supa™ Stainless Steel Care and Maintenance guide at [windowware.co.uk/supa-ss-care](http://windowware.co.uk/supa-ss-care)